

## Memorial Park Splash Pad

Design# 1193571-02-04 06/16/25

©2025 Aquatix by Landscape Structures. All Rights Reserved | aquatixplay.com

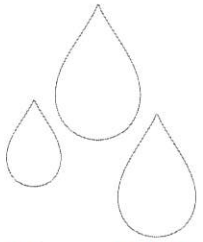



**Memorial Park Splash Pad**  
Design# 1193571-02-04 06/16/25

©2025 Aquatix by Landscape Structures. All Rights Reserved | aquatix-play.com



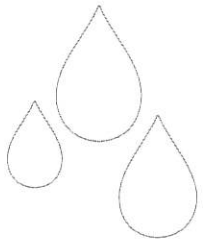

## Memorial Park Splash Pad

Design# 1193571-02-04 06/16/25

©2025 Aquatix by Landscape Structures. All Rights Reserved | aquatix + playpros.com



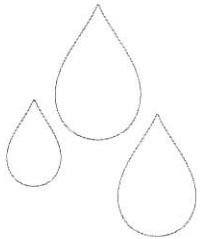

**Memorial Park Splash Pad**  
Design# 1193571-02-04 06/16/25

©2025 Aquatic By Landscape Structures. All Rights Reserved | [aquaticplay.com](http://aquaticplay.com)





## INCLUSIVE PLAY HIGHLIGHTS

**W**ater, being naturally inclusive, combined with splash play bring together people of all ages and abilities in a world of fun, learning and sensory exploration. Aquatix innovative water features allow for hands-on education tailored to every development stage. The designers at Aquatix work to deliver an educational, exploratory design that encourages physical and social development, with the ability to grow confidence while engaging in the play elements around them. This inclusive approach not only enhances community connection but also ensures there's something for everyone, making it a vibrant hub for social interaction, relaxation and unforgettable memories.

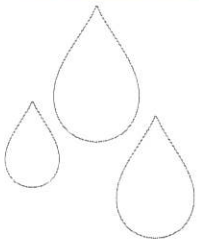

### Memorial Park Splash Pad

Design# 1193571-02-04 06/16/25

©2025 Aquatix by Landscape Structures. All Rights Reserved | [aquatix-play.com](http://aquatix-play.com)



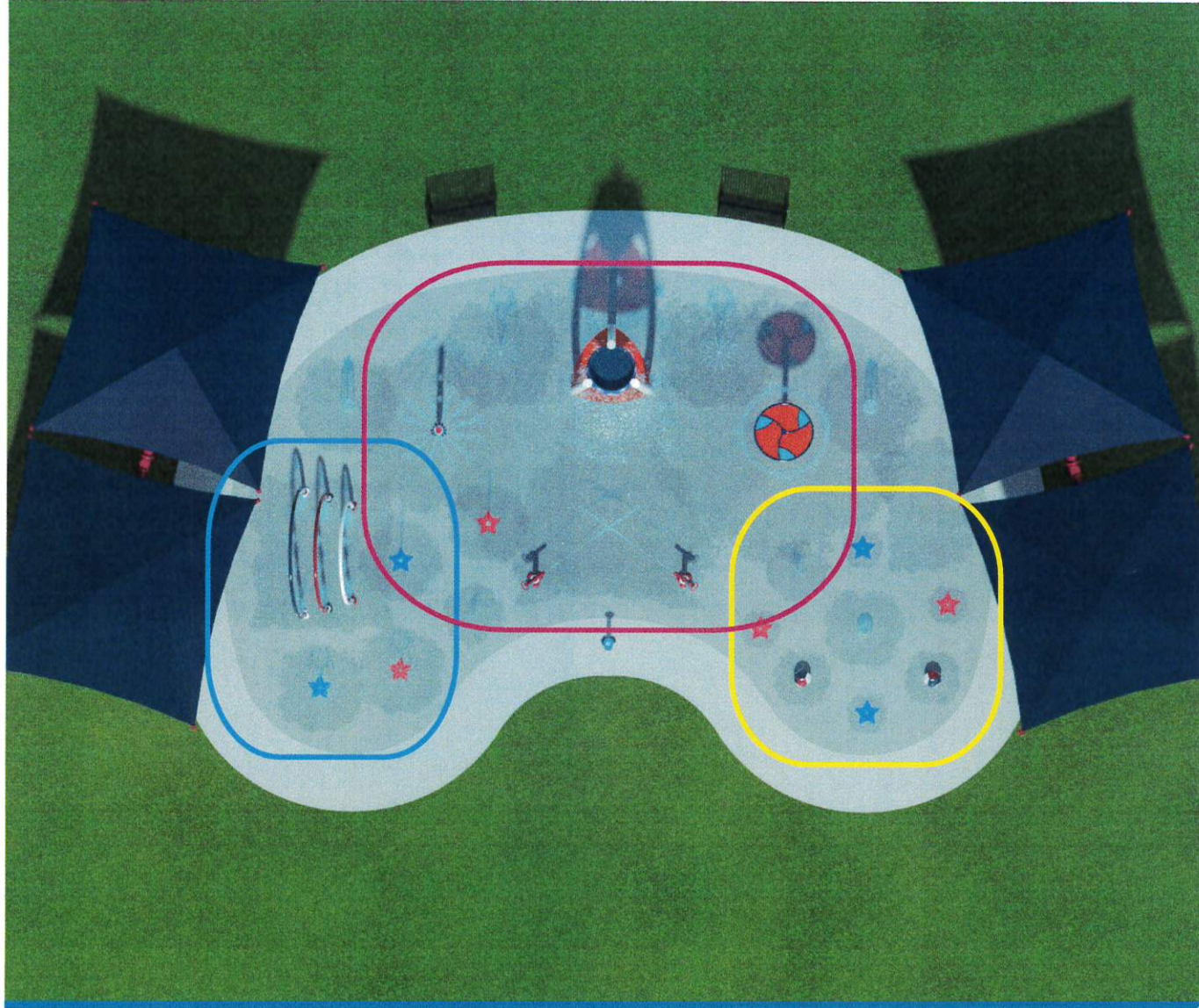

## AGE APPROPRIATE ZONES

### GENTLE ACTIVITY ZONE INFANT/TODDLER

Learning to enjoy texture and water

- Lower, delicate ground sprays
- Lower structures with gentle water formations
- Placement of features close to perimeter and dry zones ensure easy adult supervision and interaction

### UNIVERSAL ZONE ALL AGES

Variety of structures for the whole family

- Unique water formations pour, dump, spray wiggle, launch and spin
- Combines ground spray and structures for all ages
- Centrally placed in splash pad and often a transition zone from Gentle activity to Dynamic

### DYNAMIC ZONE 7+ YEARS

Continual excitement and interaction

- High Volume, highly interactive spray features and Climb 'N Play structures
- Combination of sprays and structures
- Placement of features close to perimeter and dry zones ensure easy adult supervision and interaction

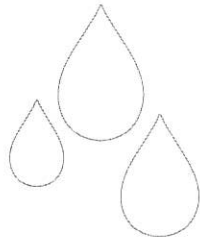

**Memorial Park Splash Pad**  
Design# 1193571-02-04 06/16/25

©2025 Aquatix by Landscape Structures. All Rights Reserved | aquatix@playpro.com





\* SHOWN IN 20' LENGTH

# RECIRCULATION SYSTEM ABOVE GROUND MECHANICAL ENCLOSURE

\*See budget estimate for project specific size.

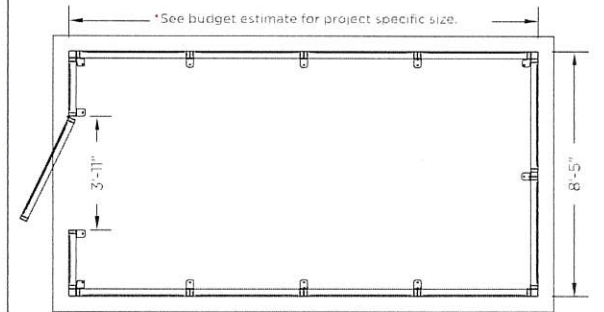
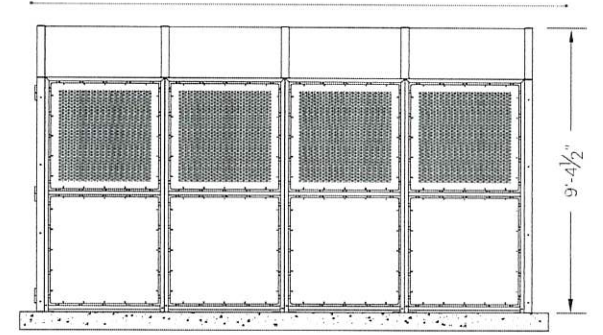

\* Available colors

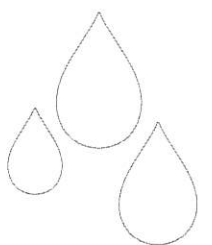

**Memorial Park Splash Pad**  
Design# 1193571-02-04 06/16/25

©2025 Aquatic by Landscape Structures. All Rights Reserved | aquatic-play.com





PROUDLY PRESENTED BY

Liv Rice  
PlayPros  
livia@playpros.com  
(866) 959-7866

## Memorial Park Splash Pad

Design# 1193571-02-04 06/16/25



# DESIGN DETAILS

\*Surface finishes and/or site furnishings shown are conceptual and provided by others.

## PROPOSED COLORS

### PAINT COLORS



### ACRYLIC COLOR(S)



### PANEL COLOR



### ENCLOSURE COLOR



## PROJECT DETAILS

### PROJECT DIMENSIONS

76'-0" X 52'-0"  
LENGTH WIDTH

### TOTAL SYSTEM FLOW RATE

300 Gallons  
CUMULATIVE PER MINUTE

### SITE FURNISHINGS

SkyWays #CP044646  
SEPARATE ELEMENT AVAILABLE FOR MODEL #

## COLOR APPROVAL



CUSTOMER SIGNATURE

6/23/2025  
DATE

\*Colors shown are for representation purposes.  
Consult with your Representative for actual color swatches for final color selection.

NO	PRODUCT	QTY	LINE SIZE	GPM
1	FLASHFLOOD	1	2"	40
2	GEOMISTER LARGE	2	1 1/2"EA	4EA
3	HYDROHELIX W/ACRYLIC	1	2"	50
4	RIPPLERUN	1	(3) 1"	30
5	ROCKETSTREAM	2	1" EA	5EA
6	SPRAYSTACKER	1	1 1/2"	30
7	TOT GROUNDSPRAY COVER	4	1" EA	5EA
8	CROWN JET	2	1" EA	5EA
9	FUNNEL TWIST W/ STAR COVER	2	1" EA	5EA
10	GROUND FUNNEL	1	1"	10
11	JUNIOR WATER JEWEL	2	1" EA	7EA
12	MINI PILLAR	2	1" EA	10EA
13	ROOSTER SPRAY	2	1" EA	7EA
14	STREAM JET W/ STAR COVER	2	1" EA	10EA
15	AQUAVATOR	1	--	--
16	COLLECTOR BOX	2	--	--

SPLASH PAD AREA: 2,137 SQ. FT.  
 APRON AREA: 1,038 SQ. FT.  
 TOTAL AREA: 3,175 SQ. FT.  
 TOTAL FEATURE FLOW RATE: 300 GPM

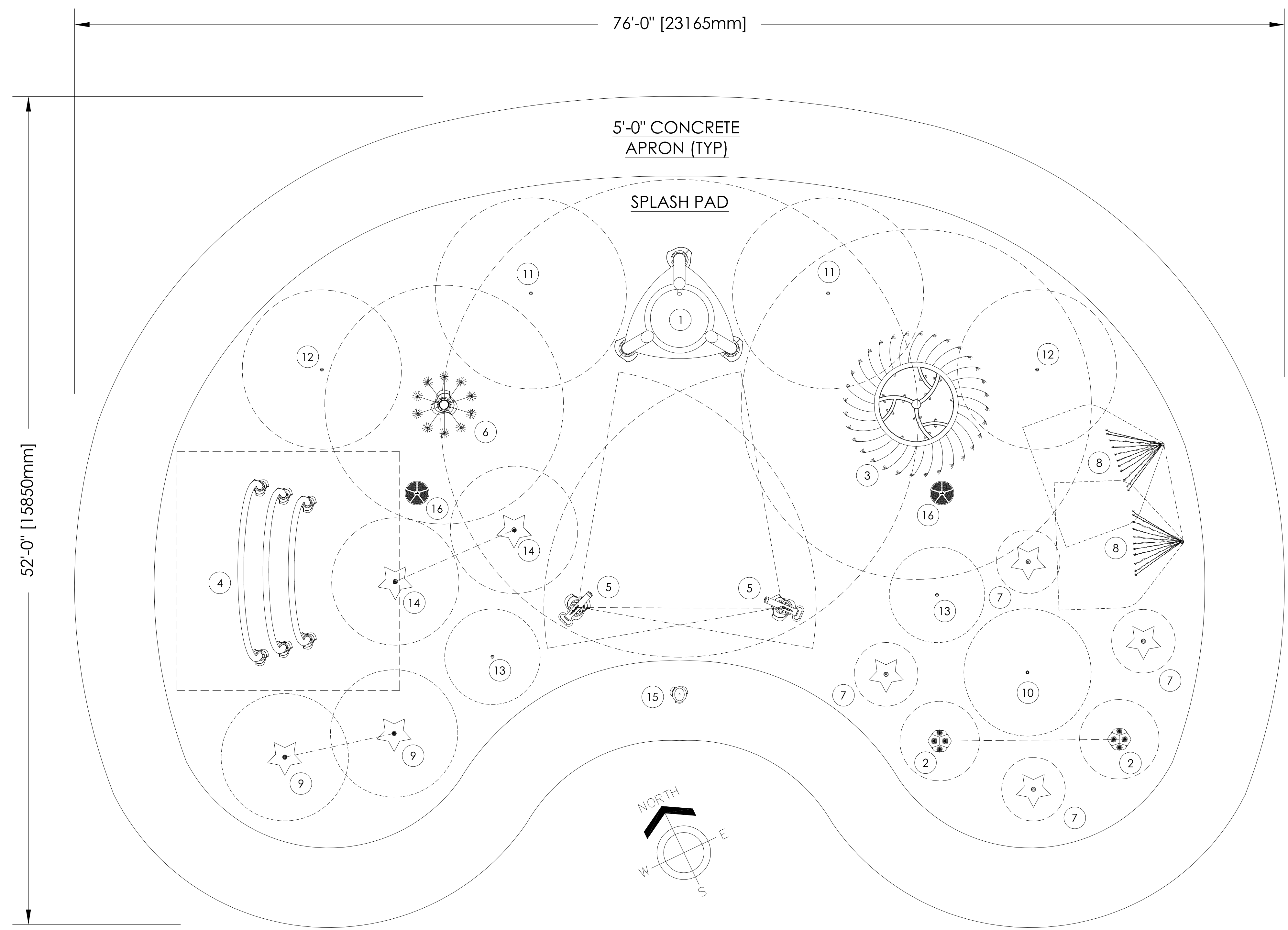

**NOT FOR  
CONSTRUCTION**

DATE	
REVISION	
NO.	
1101 McKinley Pkwy Delano, MN 55328 888-438-6574 763-972-5200 ccquiltk-playlsi.com	
JOB TITLE	MEMORIAL PARK SPLASH PAD
LOCATION	INDEPENDENCE, KY
DATE	6/16/25
DWG. FILE	
CHECKED	
DRAWN	GPC
SCALE	NOT TO SCALE
SHEET TITLE PROPOSED SPLASH PAD SCHEMATIC LAYOUT	
JOB NO. 1193571-02-04	
1 OF 2	

NO	PRODUCT	QTY	LINE SIZE	GPM
1	FLASHFLOOD	1	2"	40
2	GEOMISTER LARGE	2	1½" EA	4EA
3	HYDROHELIX W/ACRYLIC	1	2"	50
4	RIPLER/JN	1	(3) 1"	30
5	ROCKETSTREAM	2	1" EA	5EA
6	SPRAYSTACKER	1	1½"	30
7	TOT GROUNDSPRAY COVER	4	1" EA	5EA
8	CROWN JET	2	1" EA	5EA
9	FUNNEL TWIST W/ STAR COVER	2	1" EA	5EA
10	GROUND FUNNEL	1	1"	10
11	JUNIOR WATER JEWEL	2	1" EA	7EA
12	MINI PILLAR	2	1" EA	10EA
13	ROOSTER SPRAY	2	1" EA	7EA
14	STREAM JET W/ STAR COVER	2	1" EA	10EA
15	AQUAVATOR	1	--	--
16	COLLECTOR BOX	2	--	--

SPLASH PAD AREA: 2,137 SQ. FT.  
 APRON AREA: 1,038 SQ. FT.  
 TOTAL AREA: 3,175 SQ. FT.  
 TOTAL FEATURE FLOW RATE: 300 GPM

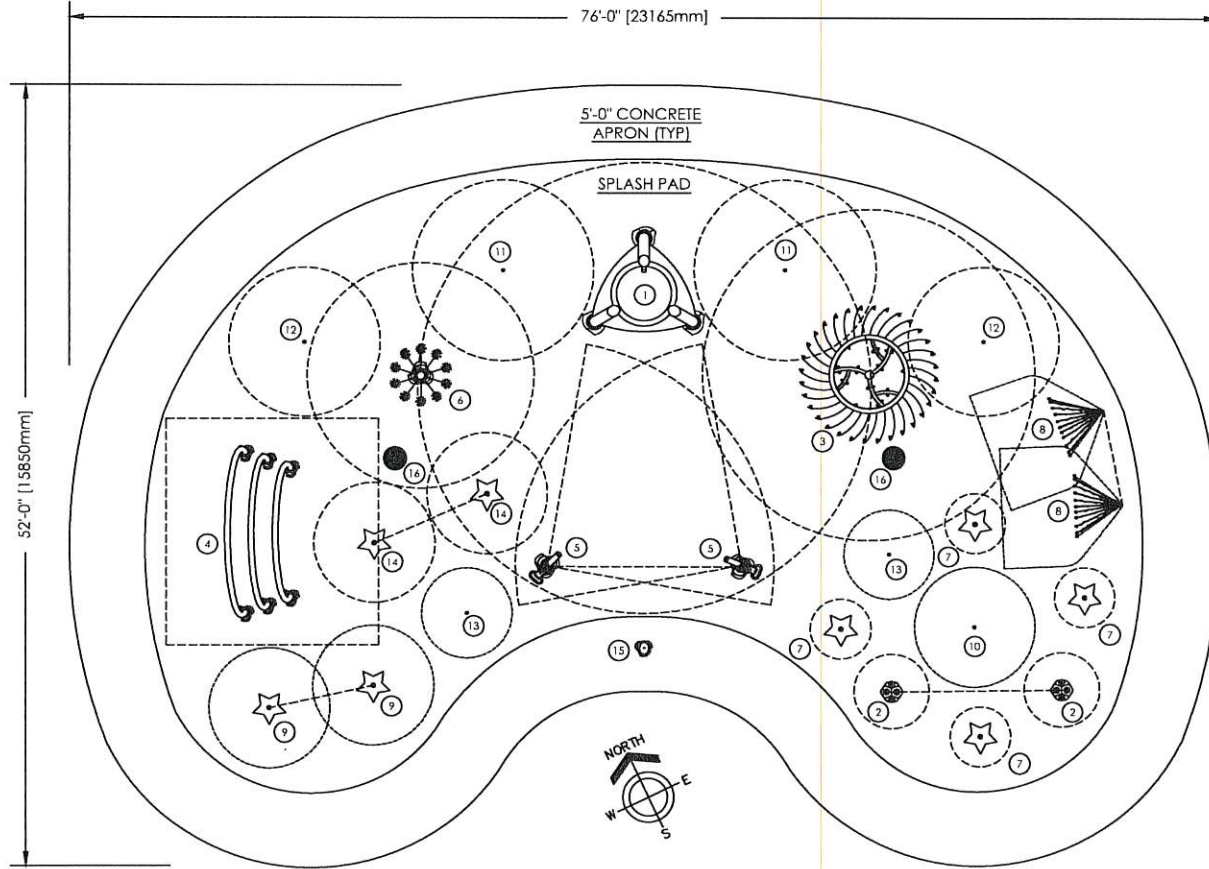

NOT FOR  
 CONSTRUCTION

DATE		DATE		DATE	
1/2	11/13/24	1/2	11/13/24	1/2	11/13/24
1101 Jack Haley Pkwy Buffalo, NY 14228 716.835.3000 <a href="http://aqualinx.com">aqualinx.com</a>					
MEMORIAL PARK SPLASH PAD JACKSON INDEPENDENCE, NY					
SCALE	CHECKED	DATE FILE	DATE	PROPOSED SPLASH PAD SCHEMATIC LAYOUT	
1/8" = 1'-0"	J.M.L./J.L.L.	11/13/24	11/13/24		
119257-02-04					
<div style="border: 1px solid black; border-radius: 50%; width: 40px; height: 40px; display: flex; align-items: center; justify-content: center; margin: 0 auto;"> <span style="font-size: 24px; font-weight: bold;">1</span>  <span style="font-size: 24px; font-weight: bold;">OF</span>  <span style="font-size: 24px; font-weight: bold;">2</span> </div>					

- NOTE:**
- ALL CONCRETE SLOPES TO BE 1/8"/FT MIN. AND 1/4"/FT MAX.
  - SITE ELEVATIONS OF SPLASH PAD AND CONCRETE APRON TO BE VERIFIED BY OTHERS. AQUATIX ELEVATION REFERENCE IS 0'-0" FOR TOP OF DRAIN BOX. ALL OTHER NOTED ELEVATIONS ARE REFERENCED FROM THAT POINT. REFER TO SPEC SHEET AND INSTALLATION DRAWING FOR EACH PRODUCT.
  - ACTUAL SIZE, SHAPE, AND LOCATION OF SPLASH PAD TO BE FIELD DETERMINED BY OTHERS. ALL DIMENSIONS OF SIZE AND SHAPE OF SPLASH PAD FOR REFERENCE ONLY.
  - THE INTENT OF A SPLASH PAD IS TO BE A DRY DECK WITH NO STANDING WATER. THE WATER IS TO BE CONTAINED WITHIN THE PERIMETER OF THE SPLASH PAD AND ALL WATER IS TO DRAIN INTO THE DRAIN BOXES. THE CONCRETE IS TO BE FORMED AND SLOPED TO ACCOMMODATE THIS DRAIN PATTERN.
  - ALL TREATED SPLASH PAD WATER IS INTENDED TO REMAIN WITHIN DESIGNATED SPLASH PAD DECK. UNDER NO CIRCUMSTANCES SHOULD SLOPE OF SPLASH PAD ALLOW WATER TO DRAIN OFF PAD.
  - UNDER NO CIRCUMSTANCES SHALL THE SURROUNDING HARDSCAPE AREA BE SLOPED TO ALLOW WATER TO BE DRAINED INTO THE SPLASH PAD DECK.
  - ALL CONCRETE SURFACES TO HAVE A MEDIUM BROOM FINISH.
  - EXPANSION JOINT TO BE EVERY 20'x20'. SAW CUT JOINT TO BE EVERY 10'x10'. COORDINATE EXPANSION JOINT AND SAW CUT LOCATIONS WITH PLAY EQUIPMENT LOCATIONS.
  - DRAWINGS ARE FOR DESIGN/LAYOUT PURPOSES ONLY. PLEASE SEE AQUATIX BY LANDSCAPE STRUCTURES FOR INCLUDED STRUCTURES, EQUIPMENT, SERVICES, AND EXCLUSIONS.
  - INDICATES SPLASH ZONE.
  - SPLASH ZONES ARE APPROXIMATE. ACTUAL SPLASH ZONE MAY VARY BASED ON VARIOUS ENVIRONMENTAL CONDITIONS, FLOW RATES, SLOPE OF THE SPLASH PAD, SUBMERGENCE DEPTH AND WIND. DRAWINGS ARE SCHEMATIC ONLY.
  - 18" OF GRANULAR FILL RECOMMENDED, OR AS SOIL CONDITIONS AND/OR LOCAL CODE REQUIRES WITH A MINIMUM OF 2500 PSF SOIL BEARING CAPACITY. THERE IS TO BE A MINIMUM OF 6" OF GRANULAR FILL AROUND ALL PIPING.
  - CONCRETE REINFORCEMENT TO BE #4 REBAR @12" O.C. EACH WAY OR EQUIVALENT WELDED WIRE MESH (#6 ON 4"x4" SPACING OR W10 ON 6"x6" SPACING)
  - CONCRETE TO BE THICKENED AT ALL PRODUCT INSTALLATION LOCATIONS (BOTH EMBED AND ABOVE GROUND STRUCTURES). REFER TO INSTALLATION DRAWINGS FOR EACH PRODUCT.
  - SCHEDULE 80 PVC TO BE UTILIZED FOR ALL SPLASH PAD MECHANICAL SYSTEM PIPING.
  - LEVEL MOUNTING AREA REQUIRED FOR ALL PRODUCTS.
  - RECOMMENDED POOL WATER DEPTHS:
    - DO NOT EXCEED 4" WATER DEPTH ON GROUND SPRAYS AND STRUCTURES UP TO 24" TALL
    - DO NOT EXCEED 12" WATER DEPTH ON STRUCTURES UP TO 48" TALL
    - DO NOT EXCEED 18" WATER DEPTH ON STRUCTURES TALLER THAN 48"
    - DO NOT EXCEED 12" WATER DEPTH ON MULTI LEVEL PLATFORMS. NO WATER SPRAY OR CRAWL TUNNEL TO BE UNDERWATER.
  - THICKENED AND LEVEL SLABS REQUIRED UNDER ENTIRE MULTI LEVEL STRUCTURES.
  - LINE SIZES ASSUME MECHANICAL SYSTEM TO BE WITHIN 100' OF SPLASH PAD.
  - SITE LAYOUT ASSUMES NO STRONG PREVAILING WINDS FROM ANY SPECIFIC DIRECTION. PLEASE ADVISE AQUATIX AS SOON AS POSSIBLE IF WIND CONDITIONS MAY EFFECT PRODUCT SPRAY ZONES.

THE SIZES ARE TYPICAL. TO BE VERIFIED DURING DESIGN.

PREFAB AND PRICING BASED ON 5FT DISTANCE AWAY FROM SPLASH PAD

**EQUIPMENT ENCLOSURE (BY AQUATIX, NTS)**  
**\*\*LOCATION TO BE CONFIRMED\*\***

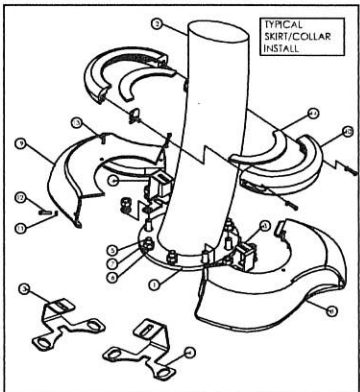
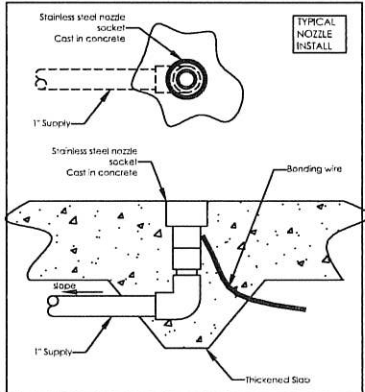
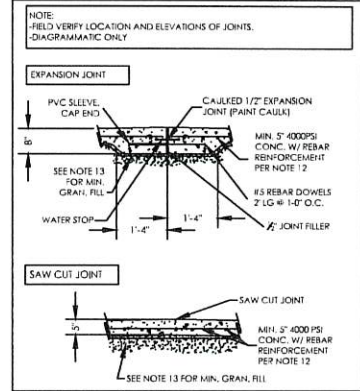
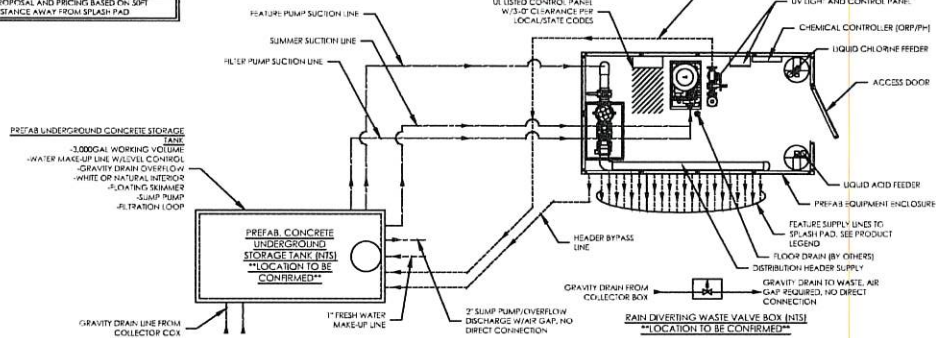

**TYPICAL SKIRT/COLLAR INSTALL**

ITEM NO.	PART NUMBER	DESCRIPTION	QTY.
1	6I GASKET	6I FLANGE GASKET	1
2	6I SKI 48-20	TYPICAL TUBE	1
3	HQ400377	6I SKIRT LOW SIDE BRACKET	1
4	HQ400376	6I SKIRT HIGH SIDE BRACKET	1
5	625 ANCHOR BOLT	5/8" SST ANCHOR BOLT	8
6	625 LOCK WASHER	5/8" LOCK WASHER	8
7	100323	5/8-11 HEX NUT SST	8
8	HQ400283	6I SKIRT LOW SIDE 1	1
9	HQ400284	6I SKIRT HIGH SIDE 1	1
10	6I SKIRT ASN	COLLAR ASSEMBLY	1
11	PR2954440	1/4" NYLON WASHER	2
12	BS04C0040SS1200	1/4-20 X 1 1/4 L SST SECURITY HEX PAN HEAD	2
13	F304C0040SS1200	1/4-20 X 1 1/4 L SST SECURITY FLAT HEAD	2

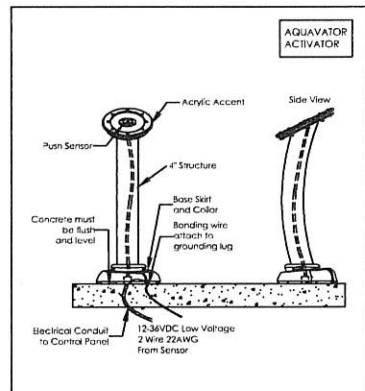
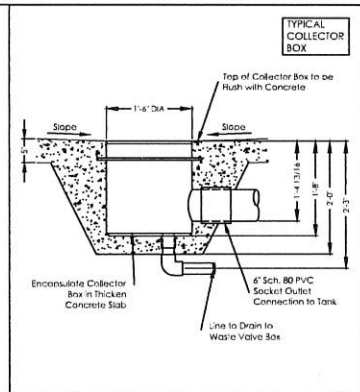

**NOT FOR CONSTRUCTION**

DATE: \_\_\_\_\_

REV: \_\_\_\_\_

1101 MERRIFIELD PKWY  
 MEMPHIS, TN 38118  
 901.586.8574  
 901.586.8574  
 901.586.8574

**aquatix**  
 by LANDSCAPE STRUCTURES

MEMPHIS PARK  
 SPLASH PAD

DATE: \_\_\_\_\_

DESIGNER: \_\_\_\_\_

CHECKED: \_\_\_\_\_

DATE: \_\_\_\_\_

SCALE: \_\_\_\_\_

PROJECT NO: 1191371-02-04

PROPOSED SPLASH PAD SCHEMATIC LAYOUT

1191371-02-04

2 OF 2

# CITY OF INDEPENDENCE

## KENTON COUNTY, KENTUCKY

# MEMORIAL PARK

# SPLASH PAD

INDEX OF SHEETS		
NO.	DWG NAME	SHEET NAME
1	TITLE	TITLE SHEET
2	NOTES	NOTES & LEGEND
3	DET	DETAILS 1
4	BMP	EROSION CONTROL DETAILS
5	DEMO	DEMOLITION PLAN
6	PLAN	GRADING, LAYOUT AND UTILITY PLAN
7	PROF	PROFILES

**CITY OF INDEPENDENCE OFFICIALS**

**MAYOR**  
CHRIS REINERSMAN

**CITY ADMINISTRATOR**  
CHRIS MORICONI

**CITY CLERK**  
GINA RAWE

**CITY COUNCIL MEMBERS**

TOM BRINKER  
CAROL FRANZEN  
MATTHEW FEHLER  
GREG STEFFEN  
CHRIS VOGELPOHL  
GREG WAITE

**CITY ATTORNEY**  
JACK GATLIN

**PUBLIC WORKS DIRECTOR**  
KEN HICKS

36727



VICINITY MAP

**K.T.C SPECIFICATIONS**

THE LATEST STANDARD SPECIFICATIONS OF THE KENTUCKY TRANSPORTATION CABINET, INCLUDING CHANGES AND SUPPLEMENTAL SPECIFICATIONS THERETO AND CITY OF INDEPENDENCE ENGINEERING DEPARTMENT REQUIREMENTS SHALL GOVERN THIS IMPROVEMENT.

**SOURCE OF BOUNDARY INFORMATION**

THE BOUNDARY INFORMATION SHOWN ON THESE PLANS IS BASED UPON KENTON COUNTY G.I.S. MAPPING AND DOES NOT REPRESENT AN ACTUAL FIELD BOUNDARY SURVEY BY VERDANTAS, LLC.

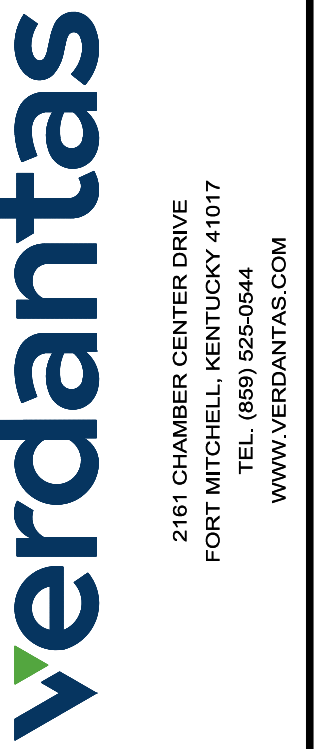

NO	REVISION	DATE

ISSUED FOR:   
 ISSUE DATE: 09/02/2025   
 SCALE:   
 DESIGNED BY: MHEL   
 DRAWN BY: EODS   
 CHECKED BY: MHEL

**MEMORIAL PARK SPLASH PAD**  
 CITY OF INDEPENDENCE  
 KENTON COUNTY, KENTUCKY

**TITLE SHEET**

PROJECT NO.	36727
DISCIPLINE	CIVIL
SHEET NAME	TTL
SHEET	OF
1	7

MARTIN P. HELLMANN

P.E. #27046

GENERAL NOTES

- 1. ALL CONSTRUCTION SHALL CONFORM TO THESE PLANS AND SPECIFICATIONS...
2. THERE SHALL BE NO DEVIATION FROM THE APPROVED PLANS WITHOUT PRIOR WRITTEN APPROVAL...
3. THE CONTRACTOR SHALL OBTAIN THE SERVICES OF A TESTING AGENCY FOR ALL REQUIRED TESTING...
4. A SUBSURFACE EXPLORATION AND GEOTECHNICAL ENGINEERING REPORT TO BE PROVIDED AT A LATER DATE...
5. THE CONTRACTOR SHALL BE RESPONSIBLE FOR ALL CONSTRUCTION LAYOUT STAKING INCLUDING HORIZONTAL AND VERTICAL CONTROL...
6. ALL WORK SHALL BE LIMITED TO THE PROPERTIES AND EASEMENTS IDENTIFIED ON THE PLANS...
7. ANY DEFECTS IN CONSTRUCTION, INCLUDING MATERIALS OR WORKMANSHIP, SHALL BE REPLACED OR CORRECTED BY THE CONTRACTOR...
8. CONTRACTOR SHALL SUBMIT A PLAN OF OPERATIONS FOR REVIEW AND APPROVAL BY THE ARCHITECT...
9. RIGHT-OF-WAY AND PROPERTY LINES SHOWN ARE PLOTTED FROM KENTON COUNTY G.I.S. MAPPING AND ARE APPROXIMATE...
10. ALL OSHA, STATE AND LOCAL SAFETY REGULATIONS SHALL BE FOLLOWED DURING CONSTRUCTION...
11. NO CONSTRUCTION SHALL COMMENCE UNTIL ALL KENTON COUNTY AND THE CITY OF INDEPENDENCE PERMITS HAVE BEEN ISSUED AS REQUIRE...
12. APPROPRIATE BARRICADES, WARNING LIGHTS, SIGNS, FENCING ETC. SHALL BE ERRECTED AROUND THE CONSTRUCTION AREA DURING NON-WORKING HOURS...
13. ANY EXISTING ROADWAY, LAWN, CURB, SIDEWALK OR OTHER APPURTENANCE DISTURBED DURING CONSTRUCTION NOT DESIGNATED FOR REMOVAL OR REPLACEMENT SHALL BE RESTORED BY THE CONTRACTOR WITHOUT ADDITIONAL COMPENSATION...
14. ANY TEMPORARY UTILITY REQUIRED BY THE CONTRACTOR (ELECTRIC, WATER ETC.) SHALL BE AT THE SOLE EXPENSE OF THE CONTRACTOR...
15. THE CONTRACTOR SHALL PRESERVE ALL BENCHMARKS, PROPERTY LINE REFERENCES, REFERENCE POINTS, STAKES AND ANY OTHER SURVEY REFERENCE...
16. ALL PROPOSED CONCRETE PAVEMENT ABUTTING EXISTING PAVEMENT SHALL BE DOWELED INTO EXISTING CONCRETE PAVEMENT USING A 3/4" DEFORMED DOWEL WITH 9" MINIMUM EMBEDMENT...
17. THE CONTRACTOR SHALL COMPLY AT ALL TIMES WITH APPLICABLE FEDERAL, STATE AND LOCAL LAWS, PROVISIONS, AND POLICIES GOVERNING SAFETY AND HEALTH...
18. THE CONTRACTOR SHALL BE RESPONSIBLE FOR EXAMINING THE AREAS AND CONDITIONS UNDER WHICH THE PROJECT IS TO BE CONSTRUCTED...
19. CONTRACTOR SHALL REFER TO OTHER PLANS WITHIN THIS CONSTRUCTION SET FOR OTHER PERTINENT INFORMATION.

ACCESSIBILITY NOTES

- 1. ALL REQUIREMENTS OF THE AMERICANS WITH DISABILITIES ACT (ADA) SHALL BE FOLLOWED IN ALL ASPECTS OF THE PROJECT.
2. ALL SIDEWALKS INSTALLED SHALL HAVE A MAXIMUM CROSS SLOPE OF 2%
3. HANDICAP ACCESSIBLE PARKING SPACES SHALL NOT EXCEED A SLOPE OF 2% IN ANY DIRECTION
4. ALL CURB RAMPS SHOWN ALONG A DESIGNATED ACCESSIBLE ROUTE SHALL BE FLUSH WITH THE ADJACENT PAVEMENT.

GAS NOTES

- 1. ALL WORK RELATING TO GAS MAINS OR GAS SERVICE LINES SHALL BE COMPLETED IN ACCORDANCE WITH THE RULES AND REGULATIONS OF THE DUKE ENERGY

ELECTRIC NOTES

- 1. ALL WORK RELATING TO ELECTRIC LINES SHALL BE COMPLETED IN ACCORDANCE WITH THE RULES AND REGULATIONS OF THE DUKE ENERGY

UTILITY NOTES

- 1. THIS PLAN SHOWS THE APPROXIMATE LOCATION OF UNDERGROUND UTILITIES (GAS, WATER, STORM SEWER, SANITARY SEWER, TELEPHONE, ELECTRIC, ETC.). THE PREPARER DOES NOT GUARANTEE THEIR ACCURACY OR CORRECTNESS...
2. PRIOR TO ANY EXCAVATION OVER AN EXISTING UTILITY LINE OR SERVICE, CONTRACTOR SHALL HAND EXCAVATE TO EXPOSE THE UTILITY AND DETERMINE LOCATION AND DEPTH...
3. TOPS OF EXISTING AND PROPOSED CASTING ELEVATIONS ARE SUBJECT TO FINAL ADJUSTMENTS AS APPROVED BY THE ENGINEER...
4. FORTY-EIGHT (48) HOURS BEFORE EXCAVATION IS TO COMMENCE, THE CONTRACTOR SHALL NOTIFY THE FOLLOWING AGENCIES...
5. THE SITE MAY CONTAIN EXISTING PRIVATELY OWNED UTILITIES...
6. RECORD DRAWINGS OF NEW UTILITY SERVICES SHALL BE PREPARED BY THE CONTRACTOR AND SUBMITTED TO THE OWNER UPON COMPLETION OF THE PROJECT.

STORM & SANITARY NOTES

- 1. ALL STORM AND SANITARY ITEMS SHALL BE IN ACCORDANCE WITH THE LATEST SPECIFICATIONS AND DETAILS FROM SD1...
2. CONTRACTOR SHALL BE REQUIRED TO MAINTAIN STORM AND SANITARY SEWER FLOW THROUGHOUT THE PROJECT...
3. IF REQUIRED, CONTRACTOR SHALL BE RESPONSIBLE FOR CONTACTING AND SCHEDULING STORM AND SANITARY SEWER INSPECTIONS...
4. CONNECTIONS INTO EXISTING OR PROPOSED STORM OR SANITARY SEWER STRUCTURES OR PIPES SHALL BE COMPLETED BY A CERTIFIED TAPPER BY SD1...
5. DOWNSPOUT AND UNDERDRAIN CONSTRUCTION SHALL MEET THESE AND THE LATEST SPECIFICATION OF THE KENTON COUNTY SUBDIVISION REGULATIONS...
6. ROOF DRAINS, FOUNDATION DRAINS AND OTHER CLEAN WATER CONNECTIONS TO THE SANITARY SEWER SYSTEM ARE PROHIBITED...
7. CONTRACTOR TO PROVIDE SHOP DRAWINGS ON ALL STORM SEWER MANHOLES, INLETS AND DETENTION SYSTEMS...
8. CONTRACTOR SHALL ASSURE THAT THERE IS POSITIVE DRAINAGE TO THE INLETS UPON PLACEMENT OF NEW PAVEMENT

WATER NOTES

- 1. ALL WORK RELATING TO WATER MAINS OR WATER SERVICE LINES SHALL BE COMPLETED IN ACCORDANCE WITH THE RULES AND REGULATIONS OF THE NORTHERN KENTUCKY WATER DISTRICT (NKWD)...
2. CONTRACTOR MAY NOT USE WATER FROM FIRE HYDRANTS WITHOUT PRIOR PERMISSION FROM NKWD
3. MAINTAIN A MINIMUM 10' HORIZONTAL SEPARATION AND 18" VERTICAL SEPARATION FROM ALL SANITARY SEWERS.

MAINTENANCE OF TRAFFIC NOTES

- 1. ALL MAINTENANCE OF TRAFFIC PROCEDURES SHALL MEET THE REQUIREMENT OF THE MANUAL OF UNIFORM TRAFFIC CONTROL DEVICES AND SECTION 112 OF KTC STANDARD SPECIFICATIONS...
2. IT SHALL BE THE CONTRACTOR'S RESPONSIBILITY TO SUBMIT TO THE ENGINEER AND THE OWNER A TRAFFIC CONTROL PLAN FOR THIS PROJECT...
3. PRIOR TO ANY CONSTRUCTION, THE CONTRACTOR SHALL NOTIFY THE CITY OF INDEPENDENCE AND THE INDEPENDENCE POLICE DEPARTMENT...
4. RESIDENTS OF THE PROJECT AREA SHALL BE ALLOWED ACCESS TO THEIR PROPERTY AT ALL TIMES...
5. ALTERNATE ROUTES OR CONTINUOUS TRAFFIC CONTROL SHALL BE EMPLOYED WHEN A PUBLIC WAY IS TEMPORARY BLOCKED DURING CONSTRUCTION...

GRADING AND EROSION CONTROL NOTES

- 1. ALL DISTURBED AREAS ARE TO BE RESTORED (SEEDED AND MULCHED) BY THE CONTRACTOR AND SHALL PROCEED WITH JOB PROGRESSION...
2. ALL APPLICABLE RECOMMENDATIONS IN KENTUCKY'S BEST MANAGEMENT PRACTICES MANUAL SHALL BE FOLLOWED BY THE CONTRACTOR...
3. ADDITIONAL BMP'S AND EROSION AND SEDIMENT CONTROL MEASURES MAY BE REQUIRED AS DEEMED NECESSARY...
4. ALL EXCAVATION IS CONSIDERED UNCLASSIFIED AND THE CONTRACTOR SHALL BE RESPONSIBLE FOR MEANS, METHODS AND MATERIALS OF CONSTRUCTION...
5. ALL TREES AND OTHER VEGETATION WITHIN THE PROJECT LIMITS THAT INTERFERE WITH CONSTRUCTION SHALL BE REMOVED...
6. THE CONTRACTOR SHALL REMOVE ALL SURPLUS DEMOLISHED AND WASTE MATERIALS, INCLUDING TREES, STUMPS, TRASH AND DEBRIS...
7. THE CONTRACTOR SHALL REMOVE FROM THE SITE ALL MATERIAL DEEMED UNSUITABLE FOR EMBANKMENT...
8. THE CONTRACTOR SHALL PROVIDE FINAL GRADING TO WITHIN 1" OF GRADES SHOWN ON THE PLANS...
9. TOPSOIL SHALL BE STRIPPED AND SOCKPILED FROM ALL AREAS TO BE GRADED...
10. EXCESS SOIL GENERATED FROM TRENCH EXCAVATIONS SHALL BE INCORPORATED IN THE UNIT PRICE BID...
11. THE CONTRACTOR SHALL FOLLOW THE RECOMMENDATIONS IN THE SUBSURFACE EXPLORATION AND GEOTECHNICAL ENGINEERING REPORT...
12. NO SLAG, RIVER GRAVEL, RECYCLED PORTLAND CEMENT CONCRETE, RECLAIMED ASPHALT CONCRETE PAVEMENT OR RECLAIMED BITUMINOUS AGGREGATE BASE SHALL BE USED AS FILL...
13. EXPOSED PAVEMENT SUBGRADE AREAS SHALL BE MAINTAINED IN CONDITIONS TO PREVENT PONDING OF WATER AFTER RAINS...
14. ALL EXISTING AND PROPOSED MANHOLE COVERS, VALVE BOXES, ETC. LOCATED WITHIN PEDESTRIAN ACCESS SHALL BE FLUSH MOUNTED...
15. SLOPE ALL PAVING AND LANDSCAPE AREAS AWAY FROM THE BUILDING AT A MINIMUM OF 1%
16. THE ENGINEER MAKES NO REPRESENTATION AS TO A BALANCED EARTHWORK SITE...
17. THE CONTRACTOR SHALL PROTECT STRUCTURES, UTILITIES, SIDEWALKS, PAVEMENTS AND OTHER FACILITIES TO REMAIN FROM DAMAGE CAUSED BY EARTHWORK OPERATIONS...
18. MAINTENANCE OF ALL TEMPORARY AND PERMANENT EROSION AND SEDIMENT CONTROL FACILITIES IS THE RESPONSIBILITY OF THE CONTRACTOR(S)
19. CONTRACTOR SHALL PROVIDE WRITTEN DOCUMENTATION OF REPAIR AND/OR REPLACEMENT OF BMP'S

EROSION CONTROL LEGEND

- IP INLET PROTECTION (SEE DETAIL)
SF PROPOSED SILT FENCE (SEE DETAIL)
CD CHECK DAM (SEE DETAIL)

HATCH LEGEND

- PAVEMENT REMOVAL
ASPHALT PATH
4" CONCRETE WALK

SYMBOL LEGEND

- EXISTING GAS LINE
EXISTING GAS SERVICE
EXISTING ELECTRIC (UNDERGROUND / OVERHEAD)
EXISTING CABLE (UNDERGROUND / OVERHEAD)
EXISTING TELEPHONE (UNDERGROUND / OVERHEAD)
EXISTING WATER MAIN
EXISTING WATER SERVICE
EXISTING STORM SEWER
EXISTING ROOF DRAIN
EXISTING SANITARY SEWER
EXISTING SANITARY FORCE MAIN
EXISTING FIBER OPTICS
EXISTING FENCE
EXISTING CONTOURS (MAJOR)
EXISTING CONTOURS (MINOR)
EXISTING RIGHT OF WAY
EXISTING PROPERTY LINE
EXISTING EASEMENT
EXISTING GUARDRAIL
EXISTING TREE LINE
PROPOSED GAS LINE
PROPOSED GAS SERVICE
EXISTING ELECTRIC (UNDERGROUND / OVERHEAD)
PROPOSED CABLE (UNDERGROUND / OVERHEAD)
PROPOSED TELEPHONE (UNDERGROUND / OVERHEAD)
PROPOSED WATER MAIN
PROPOSED WATER SERVICE
PROPOSED STORM SEWER
PROPOSED UNDERDRAIN
PROPOSED UNDERDRAIN / DOWNSPOUT COLLECTOR COMBO
PROPOSED SANITARY SEWER
PROPOSED SANITARY FORCE MAIN
PROPOSED FIBER OPTICS
PROPOSED FENCE
PROPOSED CONTOURS (MAJOR)
PROPOSED CONTOURS (MINOR)
PROPOSED RIGHT OF WAY
PROPOSED PROPERTY LINE
PROPOSED EASEMENT
PROPOSED GUARDRAIL
PROPOSED TREE LINE / CLEARING LIMITS
PROPOSED DISTURBED LIMITS
EXISTING FLAGPOLE
EXISTING MAILBOX
EXISTING SIGN
EXISTING CABLE PEDESTAL
EXISTING ELECTRIC PEDESTAL
EXISTING PULL BOX
EXISTING GROUND LIGHT
EXISTING LIGHT POLE
EXISTING ELECTRIC METER
EXISTING ELECTRIC MANHOLE
EXISTING GAS METER
EXISTING GAS VALVE
EXISTING GAS BOX
EXISTING UTILITY POLE
EXISTING GUY WIRE / ANCHOR
EXISTING SANITARY MANHOLE
EXISTING SANITARY CLEANOUT
EXISTING STORM MANHOLE
EXISTING SINGLE / DOUBLE CURB INLET
EXISTING CATCH BASIN
EXISTING STORM CLEANOUT
EXISTING TELEPHONE MANHOLE
EXISTING TELEPHONE PEDESTAL
EXISTING FIRE HYDRANT
EXISTING WATER METER
EXISTING WATER VALVE
EXISTING BUSHES / TREES
EXISTING SURVEY BENCHMARK
TEST BORING LOCATION
PROPOSED FLAGPOLE
PROPOSED MAILBOX
PROPOSED SIGN
PROPOSED CABLE PEDESTAL
PROPOSED ELECTRIC PEDESTAL
PROPOSED PULL BOX
PROPOSED GROUND LIGHT
PROPOSED LIGHT POLE
PROPOSED ELECTRIC METER
PROPOSED ELECTRIC MANHOLE
PROPOSED GAS METER
PROPOSED GAS VALVE
PROPOSED GAS BOX
PROPOSED UTILITY POLE
PROPOSED GUY WIRE / ANCHOR
PROPOSED SANITARY MANHOLE
PROPOSED SANITARY CLEANOUT
PROPOSED STORM MANHOLE
PROPOSED SINGLE / DOUBLE CURB INLET
PROPOSED CATCH BASIN
PROPOSED STORM CLEANOUT
PROPOSED TELEPHONE MANHOLE
PROPOSED TELEPHONE PEDESTAL
PROPOSED FIRE HYDRANT
PROPOSED WATER METER
PROPOSED WATER VALVE
REMOVE EXISTING BUSH / TREE
PROPOSED SLOPE DIRECTION

SYMBOL LEGEND

- EXISTING GAS LINE
EXISTING GAS SERVICE
EXISTING ELECTRIC (UNDERGROUND / OVERHEAD)
EXISTING CABLE (UNDERGROUND / OVERHEAD)
EXISTING TELEPHONE (UNDERGROUND / OVERHEAD)
EXISTING WATER MAIN
EXISTING WATER SERVICE
EXISTING STORM SEWER
EXISTING ROOF DRAIN
EXISTING SANITARY SEWER
EXISTING SANITARY FORCE MAIN
EXISTING FIBER OPTICS
EXISTING FENCE
EXISTING CONTOURS (MAJOR)
EXISTING CONTOURS (MINOR)
EXISTING RIGHT OF WAY
EXISTING PROPERTY LINE
EXISTING EASEMENT
EXISTING GUARDRAIL
EXISTING TREE LINE
PROPOSED GAS LINE
PROPOSED GAS SERVICE
EXISTING ELECTRIC (UNDERGROUND / OVERHEAD)
PROPOSED CABLE (UNDERGROUND / OVERHEAD)
PROPOSED TELEPHONE (UNDERGROUND / OVERHEAD)
PROPOSED WATER MAIN
PROPOSED WATER SERVICE
PROPOSED STORM SEWER
PROPOSED UNDERDRAIN
PROPOSED UNDERDRAIN / DOWNSPOUT COLLECTOR COMBO
PROPOSED SANITARY SEWER
PROPOSED SANITARY FORCE MAIN
PROPOSED FIBER OPTICS
PROPOSED FENCE
PROPOSED CONTOURS (MAJOR)
PROPOSED CONTOURS (MINOR)
PROPOSED RIGHT OF WAY
PROPOSED PROPERTY LINE
PROPOSED EASEMENT
PROPOSED GUARDRAIL
PROPOSED TREE LINE / CLEARING LIMITS
PROPOSED DISTURBED LIMITS
EXISTING FLAGPOLE
EXISTING MAILBOX
EXISTING SIGN
EXISTING CABLE PEDESTAL
EXISTING ELECTRIC PEDESTAL
EXISTING PULL BOX
EXISTING GROUND LIGHT
EXISTING LIGHT POLE
EXISTING ELECTRIC METER
EXISTING ELECTRIC MANHOLE
EXISTING GAS METER
EXISTING GAS VALVE
EXISTING GAS BOX
EXISTING UTILITY POLE
EXISTING GUY WIRE / ANCHOR
EXISTING SANITARY MANHOLE
EXISTING SANITARY CLEANOUT
EXISTING STORM MANHOLE
EXISTING SINGLE / DOUBLE CURB INLET
EXISTING CATCH BASIN
EXISTING STORM CLEANOUT
EXISTING TELEPHONE MANHOLE
EXISTING TELEPHONE PEDESTAL
EXISTING FIRE HYDRANT
EXISTING WATER METER
EXISTING WATER VALVE
EXISTING BUSHES / TREES
EXISTING SURVEY BENCHMARK
TEST BORING LOCATION
PROPOSED FLAGPOLE
PROPOSED MAILBOX
PROPOSED SIGN
PROPOSED CABLE PEDESTAL
PROPOSED ELECTRIC PEDESTAL
PROPOSED PULL BOX
PROPOSED GROUND LIGHT
PROPOSED LIGHT POLE
PROPOSED ELECTRIC METER
PROPOSED ELECTRIC MANHOLE
PROPOSED GAS METER
PROPOSED GAS VALVE
PROPOSED GAS BOX
PROPOSED UTILITY POLE
PROPOSED GUY WIRE / ANCHOR
PROPOSED SANITARY MANHOLE
PROPOSED SANITARY CLEANOUT
PROPOSED STORM MANHOLE
PROPOSED SINGLE / DOUBLE CURB INLET
PROPOSED CATCH BASIN
PROPOSED STORM CLEANOUT
PROPOSED TELEPHONE MANHOLE
PROPOSED TELEPHONE PEDESTAL
PROPOSED FIRE HYDRANT
PROPOSED WATER METER
PROPOSED WATER VALVE
REMOVE EXISTING BUSH / TREE
PROPOSED SLOPE DIRECTION

Project information block including: PROJECT NO. 36727, DISCIPLINE CIVIL, SHEET NAME NOTES, SHEET 2 OF 7, and company logo/verdantas.



**SEDIMENT BASINS**

**DEFINITION**  
A TEMPORARY BARRIER OR DAM CONSTRUCTED ACROSS A WATERCOURSE OR AT OTHER SUITABLE LOCATION TO RETAIN SEDIMENT AND OTHER WATERBORNE DEBRIS.

**SCOPE**  
THIS STANDARD ESTABLISHES MINIMUM ACCEPTABLE QUALITY FOR THE DESIGN AND CONSTRUCTION OF TEMPORARY SEDIMENT BASINS FORMED BY AN EMBANKMENT, EXCAVATION OR A COMBINATION OF EMBANKMENT AND EXCAVATION. THE STANDARD IS LIMITED TO SITES WHERE:

- FAILURE OF THE STRUCTURE WOULD NOT RESULT IN LOSS OF LIFE; DAMAGE TO HOMES; COMMERCIAL OR INDUSTRIAL BUILDINGS; DAMAGE TO HIGHWAYS OR RAILROADS OR INTERRUPTION OF USE OR SERVICE OF PRIVATE UTILITIES.
- THE HEIGHT OF DAM IS 25 FEET OR LESS, AS MEASURED FROM THE NATURAL STREAMBED AT THE CENTERLINE OF DAM TO THE TOP OF DAM.
- THE TOTAL VOLUME OF STORAGE IS 150 ACRE-FEET OR LESS.
- THE DRAINAGE AREA IS 100 ACRES OR LESS.
- THE BASIN WILL BE REMOVED WITHIN A THREE-YEAR PERIOD AFTER CONSTRUCTION.

**PURPOSE**  
TEMPORARY SEDIMENT BASINS ARE USED AS A MEANS OF TRAPPING AND STORING SEDIMENT FROM ERODING AREAS IN ORDER TO PROTECT DOWNSTREAM AREAS FROM DAMAGE RESULTING FROM SEDIMENTATION AND WATERBORNE DEBRIS.

**CONDITIONS WHERE PRACTICE APPLIES**  
TEMPORARY SEDIMENT BASINS APPLY WHERE PHYSICAL SITE CONDITIONS OR OTHER RESTRICTIONS PRECLUDE THE INSTALLATION OF EROSION CONTROL MEASURES TO ADEQUATELY CONTROL EROSION AND SEDIMENTATION. IT MAY BE USED DOWN-SLOPE FROM CONSTRUCTION OPERATIONS WHICH EXPOSE AREAS TO EROSION. TEMPORARY SEDIMENT BASINS WILL BE REMOVED AFTER THE EXPOSED AREAS ARE ADEQUATELY PROTECTED AGAINST EROSION BY VEGETATIVE OR MECHANICAL MEANS.

**COMPLIANCE WITH LAWS AND REGULATIONS**  
DESIGN AND CONSTRUCTION SHALL COMPLY WITH ALL LOCAL LAWS, ORDINANCES, RULES AND REGULATIONS.

**LOCATION**  
TO IMPROVE THE EFFECTIVENESS OF THE BASIN, IT SHOULD BE LOCATED SO AS TO INTERCEPT THE LARGEST POSSIBLE AMOUNT OF RUNOFF FROM THE DISTURBED AREA. THE BEST LOCATIONS ARE GENERALLY LOW AREAS AND NATURAL DRAINAGEWAYS BELOW DISTURBED AREAS. DRAINAGE INTO THE BASIN CAN BE IMPROVED BY THE USE OF DIVERSION DIKES AND DITCHES. THE BASIN MUST NOT BE LOCATED IN A LIVE STREAM BUT SHOULD BE LOCATED TO TRAP SEDIMENT-LOADED RUNOFF BEFORE IT ENTERS THE STREAM. THE BASIN SHOULD NOT BE LOCATED WHERE ITS FAILURE WOULD RESULT IN THE LOSS OF LIFE OR IN INTERRUPTION OF THE USE OR SERVICE OF PUBLIC UTILITIES OR ROADS.

**MULTIPLE USE**  
SEDIMENT BASINS MAY BE DESIGNED AS PERMANENT STRUCTURES TO REMAIN IN PLACE AFTER CONSTRUCTION IS COMPLETED. SITE CONDITIONS MAY MAKE THE USE OF THESE STRUCTURES DESIRABLE FOR STORMWATER DETENTION PURPOSES. WHEREVER THESE STRUCTURES ARE TO BECOME PERMANENT, OR IF THEY EXCEED THE SIZE LIMITATIONS OF THE DESIGN CRITERIA, THEY MUST BE DESIGNED AS PERMANENT PONDS BY A QUALIFIED PROFESSIONAL ENGINEER. PERMANENT PONDS ARE BEYOND THE SCOPE OF THESE STANDARDS AND SPECIFICATIONS. THE PERMANENT STRUCTURES MUST BE SUBMITTED WITH CONSTRUCTION DRAWINGS FOR REVIEW AND ACCEPTANCE BY THE CITY ENGINEER.

**MAINTENANCE BASINS SHALL BE CHECKED WEEKLY AND CLEANED WHEN NO LONGER EFFECTIVE.**

**STORM DRAIN INLET PROTECTION**  
**DEFINITION**  
A SEDIMENT FILTER INSTALLED AROUND A STORM DRAIN INLET OR CURB INLET TO REDUCE SEDIMENT DISCHARGE.

**PURPOSE**  
TO PREVENT SEDIMENT FROM ENTERING THE STORM DISCHARGE SYSTEMS PRIOR TO PERMANENT STABILIZATION OF THE DISTURBED DRAINAGE AREA. DIFFERENT TYPES OF STRUCTURES ARE APPLICABLE TO DIFFERENT CONDITIONS.

**STORM WATER POLLUTION PREVENTION NOTES**

- SANITATION DISTRICT NO. 1 IS TO BE CONTACTED 72 HOURS PRIOR TO ANY CONSTRUCTION ACTIVITY AT 859-576-6892
- ALL EROSION AND SEDIMENTATION CONTROL SHALL BE PERFORMED AS SHOWN ON THE PLANS, AND SHALL BE IN COMPLIANCE WITH THE LATEST CONSTRUCTION ACTIVITY "NATIONAL POLLUTANT DISCHARGE ELIMINATION SYSTEM" RULES AND REGULATIONS.
- A COPY OF THE STORM WATER POLLUTION PREVENTION PLAN (SWPPP) AND A COPY OF THE "NOTICE OF INTENT" (NOI) SHALL BE KEPT ON SITE.
- AN AMENDMENT OF THE SWPPP IS REQUIRED WHENEVER A CHANGE IN DESIGN, CONSTRUCTION, AND OPERATION OR MAINTENANCE HAS A SIGNIFICANT EFFECT ON THE POTENTIAL FOR THE DISCHARGE OF POLLUTANTS, OR IF THE SWPPP PROVES TO BE INEFFECTIVE IN ACHIEVING THE GENERAL OBJECTIVES OF THE SWPPP.
- THE CONTRACTOR SHALL ALSO MAINTAIN THE FOLLOWING RECORDS ON SITE:
  - GENERAL CONTRACTOR AND/OR SUBCONTRACTOR SWPPP CERTIFICATIONS
  - THE DATE, TIME, AND EXACT LOCATION OF THE INSPECTION, AND THE NAME OF THE INSPECTOR
  - AN ASSESSMENT OF THE CONDITION OF THE EROSION CONTROLS
  - A DESCRIPTION OF ANY EROSION CONTROL IMPLEMENTATION AND MAINTENANCE PERFORMED
  - A DESCRIPTION OF THE PRESENT PHASE OF CONSTRUCTION AT THE SITE
- CONSTRUCTION SEQUENCE
  - ALL PERIMETER SILT FENCE, INLET PROTECTION AND OTHER EROSION CONTROLS SHALL BE IN PLACE BEFORE ANY OTHER EARTH MOVING ACTIVITIES BEGIN.
  - THE CONTRACTOR SHALL CLEAR AND GRUB ONLY THE AREAS PLANNED FOR EARTH MOVING.
  - REMOVE TOPSOIL, STOCKPILE IT, AND INSTALL SILT FENCE AROUND PERIMETER.
  - SEED SOIL STOCKPILE WITH PERENNIAL RYE GRASS AND MULCH WITH STRAW IF NO TO BE DISTURBED FOR MORE THAN 21 DAYS.
  - CONSTRUCT DETENTION BASIN AND CONTROL STRUCTURE. DETENTION BASIN SHALL BE USED AS A SEDIMENT BASIN UNTIL THE SITE IS STABILIZED.
  - INSTALL STORM SEWER SYSTEM AND SURFACE STORM INLET AND MANHOLE PROTECTION.
  - ESTABLISH A TEMPORARY SEEDING ON ALL BARE AREAS THAT ARE TO REMAIN UNDISTURBED FOR MORE THAN 21 DAYS. SEED WITH PERENNIAL RYE GRASS MULCH WITH STRAW.
  - IMMEDIATE AFTER TOPSOIL HAS BEEN PLACED, STABILIZE THE SAME SURFACE AREA WITH FINAL SEED AND MULCH 7 DAYS AFTER REACHING FINAL GRADE.
  - AFTER THE VEGETATION HAS BECOME WELL ESTABLISHED, REMOVE TEMPORARY EROSION OR SEDIMENT CONTROL PRACTICES.
- EROSION CONTROLS MUST BE INSPECTED ONCE EVERY 7 DAYS AND WITHIN 24 HOURS OF 0.5" OR GREATER RAINFALL. REMOVE ACCUMULATED SEDIMENT FROM EROSION CONTROLS.
- TEMPORARY SEEDING SHALL BE PERENNIAL RYE GRASS (40 LB / ACRE) AND MULCH AT 3 BALES OF STRAW PER 1000 S.F.
- CONTRACTOR IS RESPONSIBLE FOR OBTAINING BORROW MATERIAL ON-SITE AND / OR DISPOSING OF EXCESS MATERIAL OFF SITE AS REQUIRED TO MEET INDICATED DESIGN ELEVATIONS.
- DEBRIS SHALL BE COLLECTED WITHIN PROPERTY LIMITS WEEKLY OR AS NEEDED FOR PUBLIC SAFETY. SURROUNDING STREETS AFFECTED BY THE CONSTRUCTION SHALL BE CLEANED DAILY OR AS NEEDED FOR PUBLIC SAFETY. SEE CONSTRUCTION ENTRANCE DETAIL IN SWPPP DETAILS SHEET.
- THE CONSTRUCTION OF BMPs SHALL BE REVISED OR ADDED IF DEEMED NECESSARY PER SECTION 1000 OF THE SANITATION DISTRICT 1 REGULATIONS.
- CONTACT SANITATION DISTRICT NO. 1 72 HOURS PRIOR TO INSTALLATION OF THE WATER QUALITY FEATURE.

**NOTES:**

- SUBSOILING SHALL OCCUR WHEN SOIL MOISTURE IS LOW ENOUGH TO ALLOW THE SOIL TO CRACK OR FRACTURE. SUBSOILING IS NOT PERMITTED ON SLIP-PRONE AREAS.
- THE SITE SHALL BE GRADED TO PERMIT THE USE OF CONVENTIONAL EQUIPMENT FOR SEEDBED PREPARATION AND SEEDING.
- TOPSOIL SHALL BE APPLIED WHERE NEEDED TO ESTABLISH VEGETATION.
- THE SEEDBED SHALL BE PREPARED BY APPLYING AGRICULTURAL GROUND LIMESTONE OR FERTILIZER AS RECOMMENDED BY A SOIL TEST. IN LIEU OF A SOIL TEST, APPLY LIME AT 2 TONS/AC. OR FERTILIZER AT 500 LB/AC. OF 10-10-10 OR 12-12-12 ANALYSIS. LIME AND FERTILIZER SHALL BE WORKED INTO THE SOIL TO A DEPTH OF 3".
- APPLY SEED UNIFORMLY ON FIRM, MOIST SEED BED.
- SEEDING SHOULD BE APPLIED FROM MARCH 1 TO MAY 31 OR AUGUST 1 TO SEPTEMBER 30. IF SEEDING OCCURS OUTSIDE OF THESE DATES, ADDITIONAL MULCH AND IRRIGATION MAY BE REQUIRED TO ENSURE A MINIMUM OF 80% GERMINATION. TILLAGE FOR SEEDBED PREPARATION SHALL OCCUR WHEN THE SOIL IS DRY ENOUGH TO CRUMBLE AND NOT FORM RIBBONS WHEN COMPRESSED BY HAND.
- SEEDING SHOULD NOT BE APPLIED FROM OCTOBER 1 TO NOVEMBER 20 BECAUSE SEEDS MAY GERMINATE, BUT WILL NOT SURVIVE THE WINTER. USE THE FOLLOWING METHODS FOR DORMANT SEEDING:
  - FROM OCTOBER 1 TO NOVEMBER 20, INCREASE THE SEEDING RATE BY 50%. PREPARE THE SEED BED, ADD LIME AND FERTILIZER, MULCH AND ANCHOR.
  - FROM NOVEMBER 20 TO MARCH 15, ONLY IF SOIL CONDITIONS PERMIT, INCREASE THE SEEDING RATE BY 50%. PREPARE THE SEED BED, ADD LIME AND FERTILIZER, APPLY THE SEED MIXTURE, MULCH AND ANCHOR.
- APPLY MULCH MATERIAL IMMEDIATELY AFTER SEEDING.
- PERMANENT SEEDING SHALL INCLUDE IRRIGATION TO ESTABLISH VEGETATION DURING DRY OR HOT WEATHER OR ON ADVERSE SITE CONDITIONS AS NEEDED. AVOID EXCESSIVE IRRIGATION AND MONITOR TO PREVENT EROSION AND DAMAGE FROM RUNOFF.
- PERMANENT SEEDING SHALL NOT BE CONSIDERED ESTABLISHED FOR AT LEAST 1 FULL YEAR FROM THE TIME OF PLANTING. DURING THIS PERIOD, INSPECT FOR SOIL EROSION OR PLANT LOSS AND REPAIR BARE OR SPARSE AREAS. FILL GULLIES, RE-FERTILIZE, RE-SEED OR RE-MULCH AS NEEDED.
- A MINIMUM OF 70% GROWTH DENSITY, BASED ON A VISUAL INSPECTION, MUST EXIST FOR AN ADEQUATE PERMANENT VEGETATIVE PLANTING.

PERMANENT SEEDING FERTILIZATION AND MOWING CHART				
MIXTURE	FORMULA	LB/AC.	TIME	MOW
CREeping RED FESCUE DOMESTIC RYEGRASS KENTUCKY BLUEGRASS	10-10-10	500	FALL, YEARLY, OR AS NEEDED	≥3"
TALL FESCUE	10-10-10	500		≥4"
TURF-TYPE FESCUE	10-10-10	500		
CROWN VETCH FESCUE	0-20-20	400	SPRING, AND YEARLY AFTER ESTABLISHED	DO NOT MOW
FLAT PEA FESCUE	0-20-20	400		

PERMANENT SEEDING SPECIES SELECTION			
SEED MIX	SEED RATE LB/AC.	NOTES:	
GENERAL USE			
CREeping RED FESCUE	20 - 40	FOR CLOSE MOWING AND	
DOMESTIC RYEGRASS	10 - 20	WATERWAYS WITH <math>-2.0</math>	
KENTUCKY BLUEGRASS	20 - 40	FT./SEC. VELOCITY	
TALL FESCUE	40 - 50		
TURF-TYPE FESCUE	90		
STEep BANKS OR CUT SLOPES			
TALL FESCUE	40 - 50		
CROWN VETCH	10 - 20	DO NOT SEED LATER THAN	
TALL FESCUE	20 - 30	AUGUST	
FLAT PEA	20 - 25	DO NOT SEED LATER THAN	
TALL FESCUE	20 - 30	AUGUST	
ROAD DITCHES AND SWALES			
TALL FESCUE	40 - 50		
TURF-TYPE FESCUE	90		
KENTUCKY BLUEGRASS	100 - 120		
PERENNIAL RYEGRASS	100 - 120		
LAWN			
KENTUCKY BLUEGRASS	100 - 120	FOR SHADED AREAS	
CREeping RED FESCUE	100 - 120		

**PERMANENT SEEDING DETAIL**  
SCALE: NONE

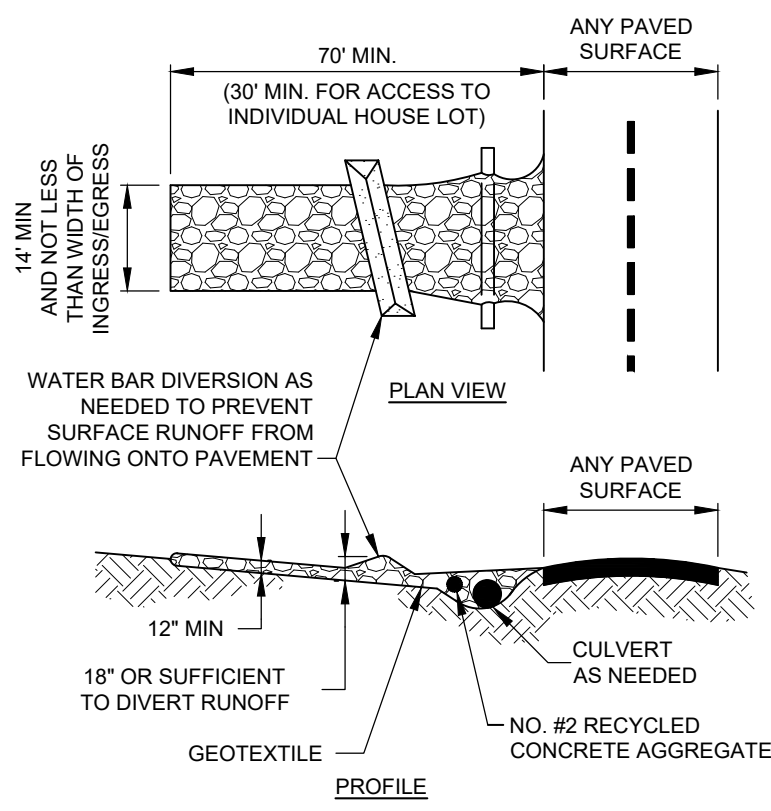

- NOTES:**
- PLACE GEOTEXTILE OVER THE ENTIRE AREA PRIOR TO PLACING STONE MEETING THE MIN. SPECIFICATIONS:
    - A. TENSILE STRENGTH = 200 LBS.
    - B. PUNCTURE STRENGTH = 80 PSI
    - C. TEAR STRENGTH = 50 LBS.
    - D. BURST STRENGTH = 320 PSI
    - E. ELONGATION = 20%
    - F. EQUIVALENT OPENING SIZE ≤ 0.6 MM
    - G. PERMITTIVITY = 0.001 CM/SEC
  - APPLY ADDITIONAL STONE AS CONDITIONS DEMAND AND REPLENISH STONE WHEN THE DEPTH IS LESS THAN 6". REMOVE AND REPLACE IF STONES BECOMES MUD-LADEN.
  - IMMEDIATELY REMOVE MUD DROPPED, WASHED OR TRACKED ONTO ROADS OR ANY SURFACE WHERE RUNOFF IS NOT CHECKED BY SEDIMENT CONTROLS BY SCRAPING OR SWEEPING.
  - CONSTRUCTION ENTRANCES SHALL NOT BE RELIED UPON TO REMOVE MUD FROM VEHICLES OR TO PREVENT OFF-SITE TRACKING. VEHICLES THAT ENTER AND LEAVE THE CONSTRUCTION SITE SHALL BE RESTRICTED FROM MUDDY AREAS.

**CONSTRUCTION ENTRANCE**  
SCALE: NONE

- NOTES:**
- THE SEED BED SHALL BE PULVERIZED AND LOOSE TO ENSURE THE SUCCESS OF ESTABLISHING VEGETATION.
  - SOIL AMENDMENTS MAY BE REQUIRED TO ESTABLISH ADEQUATE VEGETATION. PERFORM SOIL TESTS ON THE SITE TO PREDICT THE NEED FOR LIME AND FERTILIZER.
  - APPLY SEED UNIFORMLY. COVER BROADCAST SEED BY RAKING OR DRAGGING AND THEN LIGHTLY TAMPING INTO PLACE.
  - APPLY MULCHING IMMEDIATELY AFTER SEEDING.
  - SEEDING SHALL BE INSPECTED FOR BARE SPOTS AND WASHOUTS, AND RESEED AS NECESSARY.

TEMPORARY SEEDING SPECIES SELECTION				
DATES	SPECIES	LB/1,000 SF	LB/AC.	
MARCH 1 TO AUGUST 15	OATS	3	128	
	TALL FESCUE	1	40	
	PERENNIAL RYEGRASS	1	40	
AUGUST 16 TO NOVEMBER 1	PERENNIAL RYEGRASS	2	40	
	TALL FESCUE	1	40	
	RYE	3	112	
NOVEMBER 1 TO SPRING	TALL FESCUE	1	40	
	PERENNIAL RYEGRASS	1	40	
	WHEAT	3	120	
NOVEMBER 1 TO SPRING	TALL FESCUE	1	40	
	PERENNIAL RYEGRASS	1	40	
	TALL FESCUE	2	40	
NOVEMBER 1 TO SPRING	PERENNIAL RYEGRASS	1	40	
	TALL FESCUE	1	40	

**TEMPORARY SEEDING DETAIL**  
SCALE: NONE

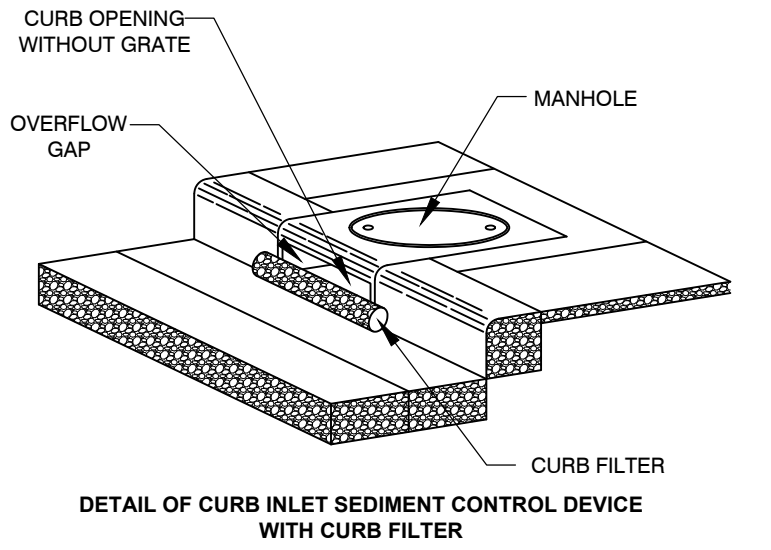

**DANDY CURB**  
SCALE: NONE

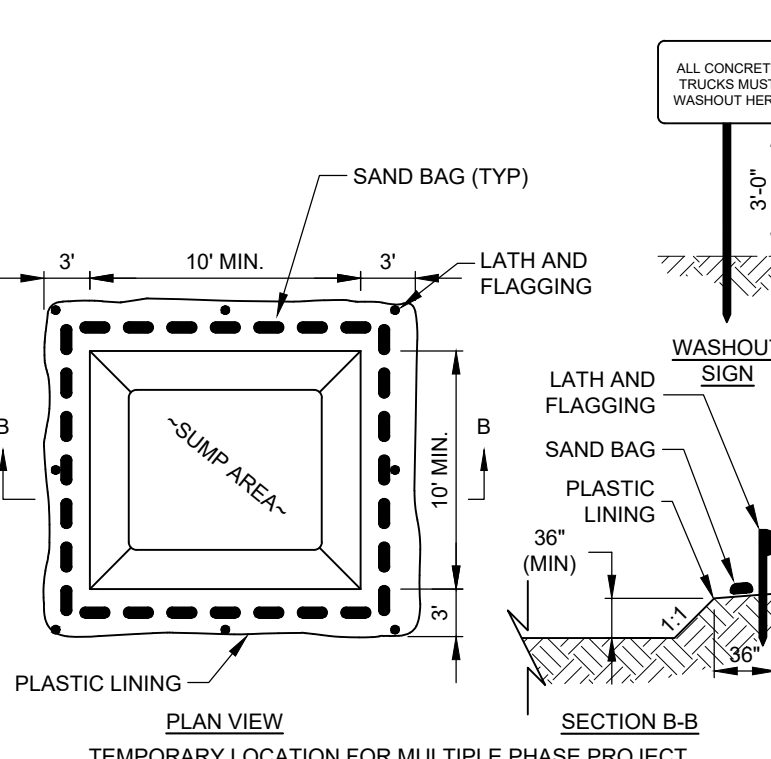
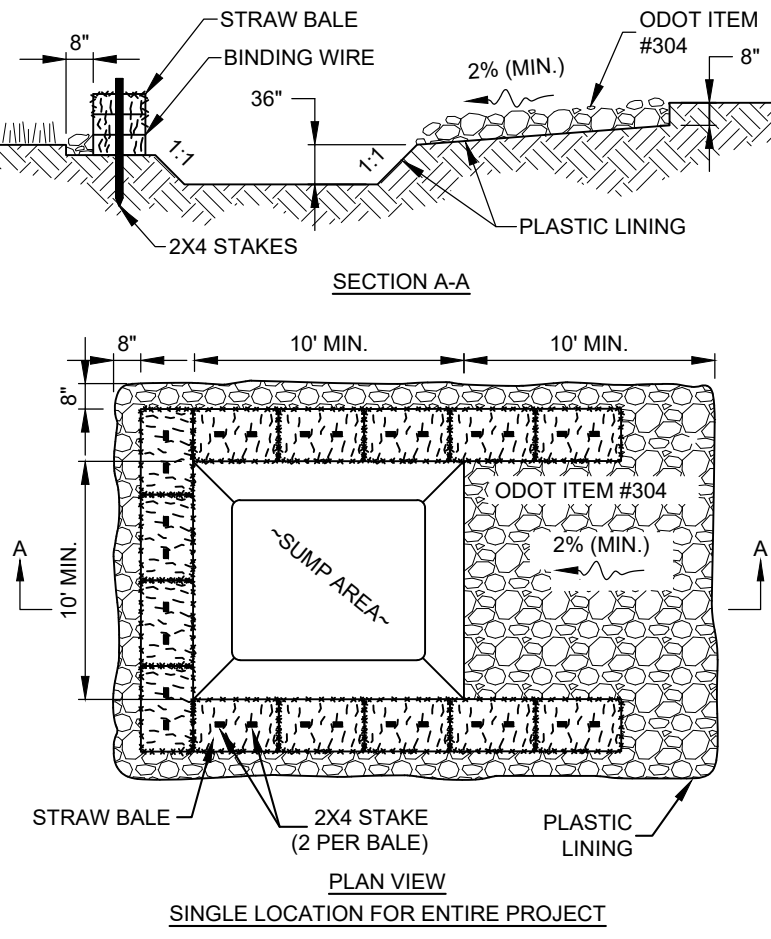

- NOTES:**
- WASHOUT PIT SHALL BE LOCATED 100' MINIMUM FROM INLETS, STREAMS, WETLANDS AND ANY OTHER SURFACE WATERS.
  - ALL EXCESS CONCRETE AND CONCRETE WASHOUT, INCLUDING FROM HAND MIXERS AND LIGHT EQUIPMENT, SHALL BE DISPOSED OF IN THE CONCRETE WASHOUT AREA. DISPOSAL OF EXCESS CONCRETE OR CONCRETE WASHOUT ON THE GROUND, OR IN STORM DRAINS, DITCHES OR WATER BODIES, IS PROHIBITED.
  - CONCRETE WASHOUT AREA SHALL BE SUFFICIENT SIZE TO CONTAIN CONCRETE WASTE GENERATED. FOR LARGER SITES, MULTIPLE CONCRETE WASHOUT AREAS MAY BE REQUIRED.
  - IF CONCRETE WASHOUT AREA IS LOCATED AWAY FROM A PAVED SURFACE, CONSTRUCT A GRAVEL ACCESS ROUTE EQUAL IN COMPOSITION TO THE CONSTRUCTION ENTRANCE.
  - POLYETHYLENE SHEETING SHALL BE DOUBLE-LINED, CONTINUOUS 10-ML POLYETHYLENE SHEETING FREE OF HOLES, TEARS OR OTHER DEFECTS, AND INSTALLED ON A SMOOTH, LEVEL SURFACE, FREE OF ROCKS OR DEBRIS.
  - CONCRETE WASHOUT SIGNAGE SHALL BE CLEARLY VISIBLE AND LOCATED WITHIN 30 FEET OF EACH WASHOUT AREA.
  - CONCRETE WASHOUT AREAS SHALL BE COVERED DURING INCLEMENT WEATHER TO PREVENT OVERFLOWS.
  - PREFABRICATED, PORTABLE AND RE-USABLE CONCRETE WASHOUT CONTAINERS ARE ACCEPTABLE, BUT MUST BE SPECIFICALLY DESIGNED FOR CONCRETE WASHOUT USE.
  - CONCRETE WASHOUT AREA SHALL BE INSPECTED DAILY TO CHECK FOR DAMAGE AND TO DETERMINE IF IT NEEDS CLEANED OR REPLACED. ANY DAMAGE TO THE SIDEWALLS OR POLYETHYLENE SHEETING SHALL BE REPAIRED IMMEDIATELY. THE CONCRETE WASHOUT AREA SHALL BE CLEANED OR REPLACED WHEN IT IS 75% FULL. THE POLYETHYLENE SHEETING SHALL BE REPLACED AFTER EACH CLEANING.
  - SAW CUT CONCRETE, RESIDUE FROM SAW CUT, AND GRINDINGS SHALL BE DISPOSED OF IN THE WASHOUT PIT.

**CONCRETE WASHOUT DETAIL**  
SCALE: NONE

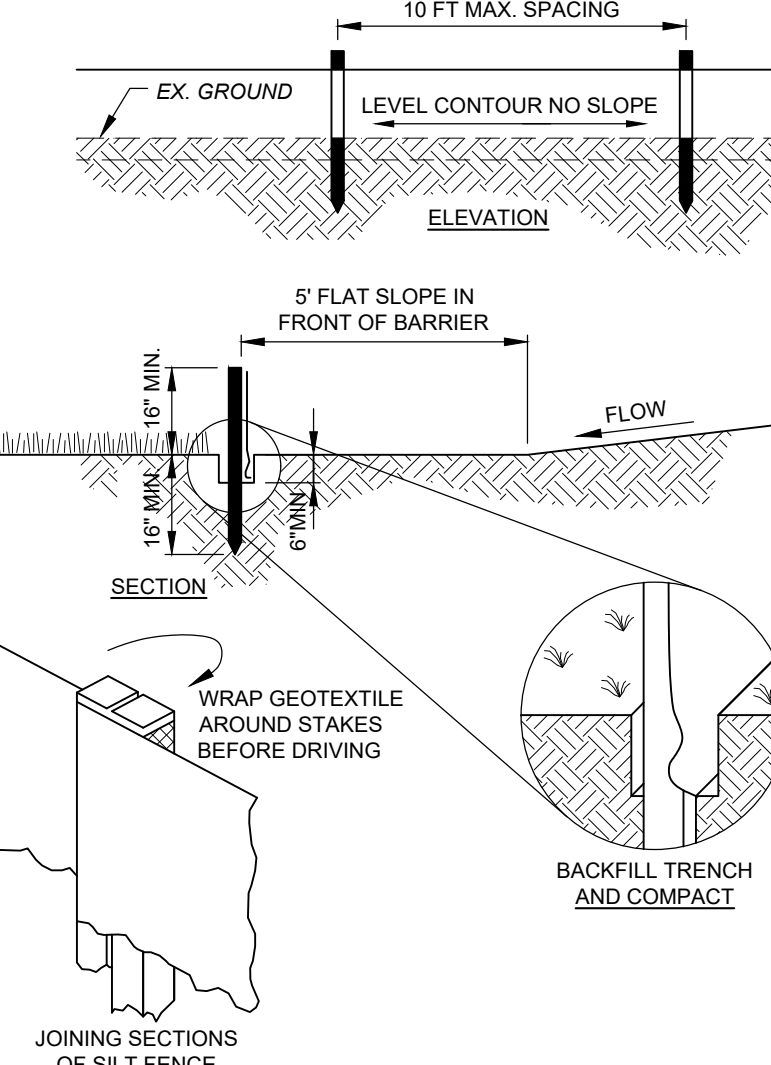

- NOTES:**
- PRESERVE VEGETATION FOR 5 FEET, OR AS MUCH AS POSSIBLE, UPSLOPE FROM THE SILT FENCE. IF VEGETATION IS REMOVED, IT SHALL BE RE-ESTABLISHED WITHIN 7 DAYS FROM SILT FENCE INSTALLATION.
  - SILT FENCE SHALL ALLOW RUNOFF TO PASS ONLY AS DIFFUSE FLOW THROUGH THE GEOTEXTILE. PERFORM ONE OF THE FOLLOWING IF RUNOFF OVERTOPS THE SILT FENCE, FLOWS UNDER OR AROUND THE ENDS, OR IN ANY OTHER WAY BECOMES A CONCENTRATED FLOW:
    - CHANGE THE LAYOUT OF THE SILT FENCE.
    - REMOVE ACCUMULATED SEDIMENT.
    - INSTALL OTHER PRACTICES.

FABRIC PROPERTIES	VALUES	TEST METHOD
GRAB TENSILE STRENGTH	90 LB. MIN	ASTM D-1682
MULLEN BURST STRENGTH	190 PSI MIN	ASTM D-3786
SLURRY FLOW RATE	0.3 GAL./MIN./S.F. MAX.	
EQUIVALENT OPENING SIZE	40-80	US STD. SIEVE CW-02215
ULTRAVIOLET RADIATION STABILITY	90% MIN	ASTM-G-26

**SILT FENCE**  
SCALE: NONE

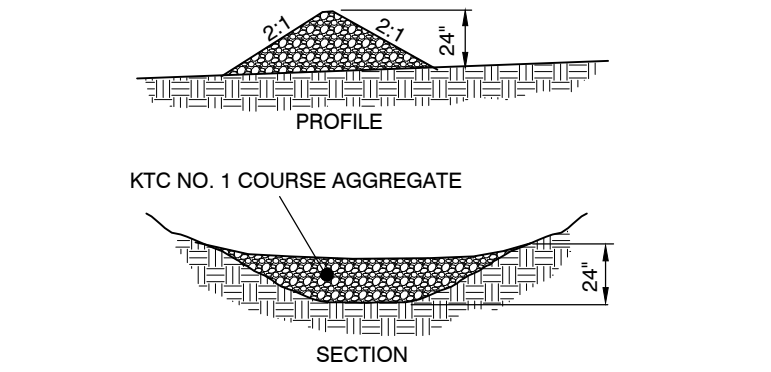

**CHECK DAM**  
SCALE: NONE

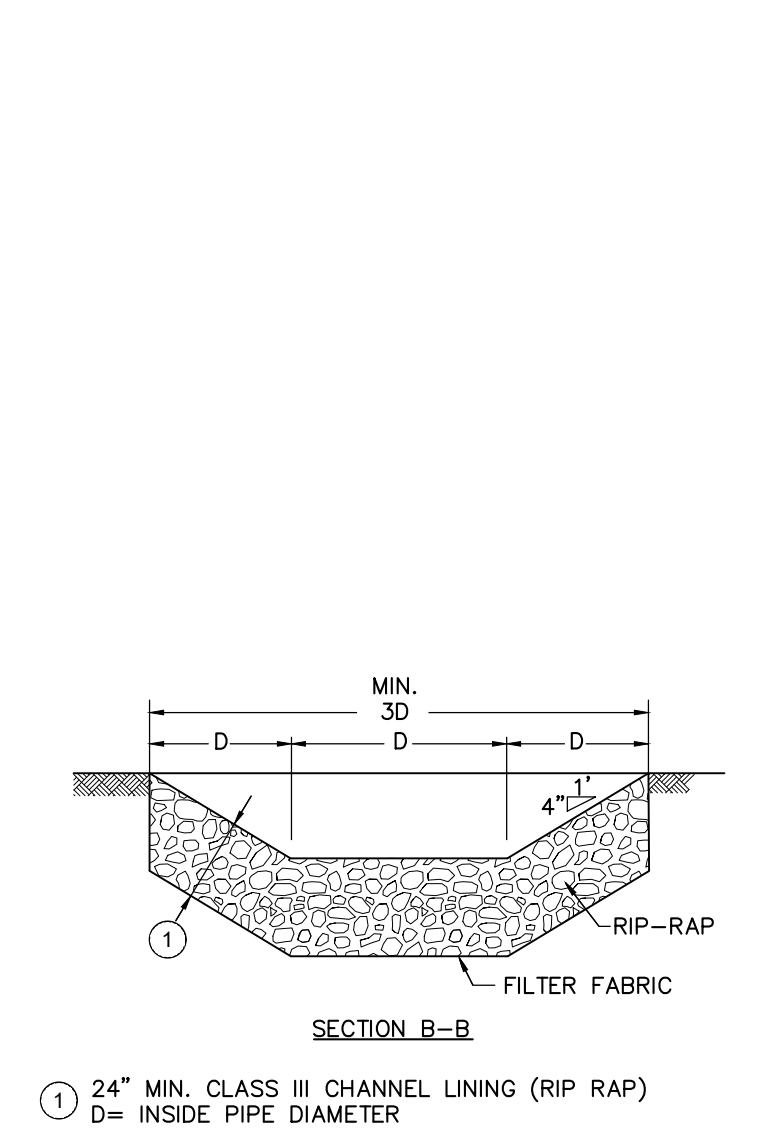

**ROCK CHANNEL PROTECTION**  
SCALE: NONE

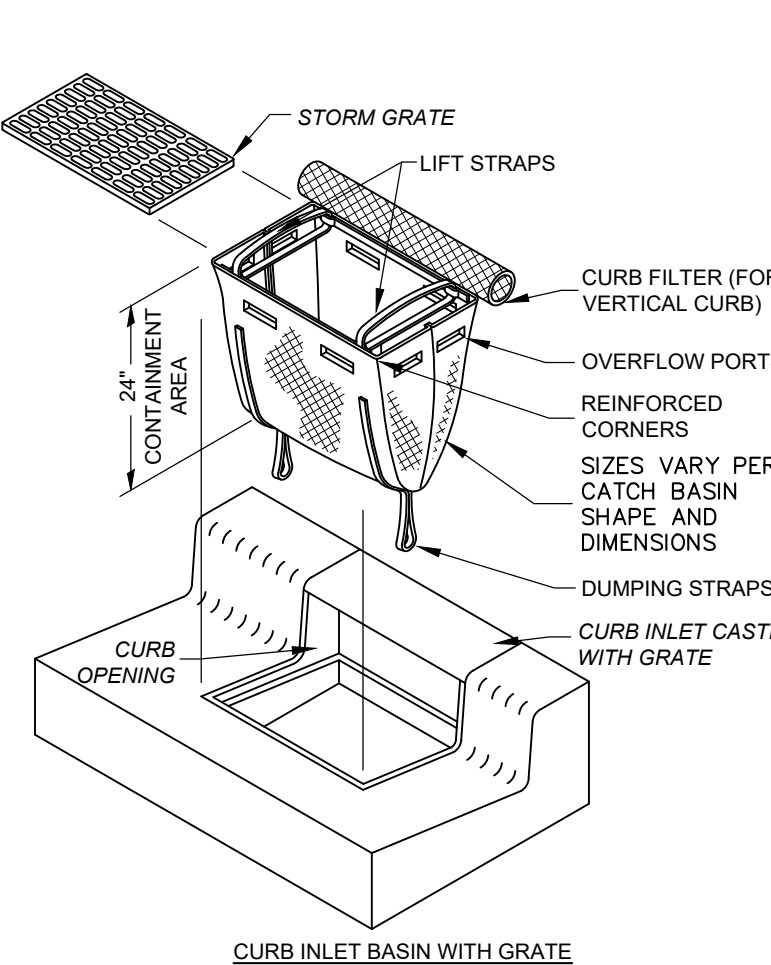
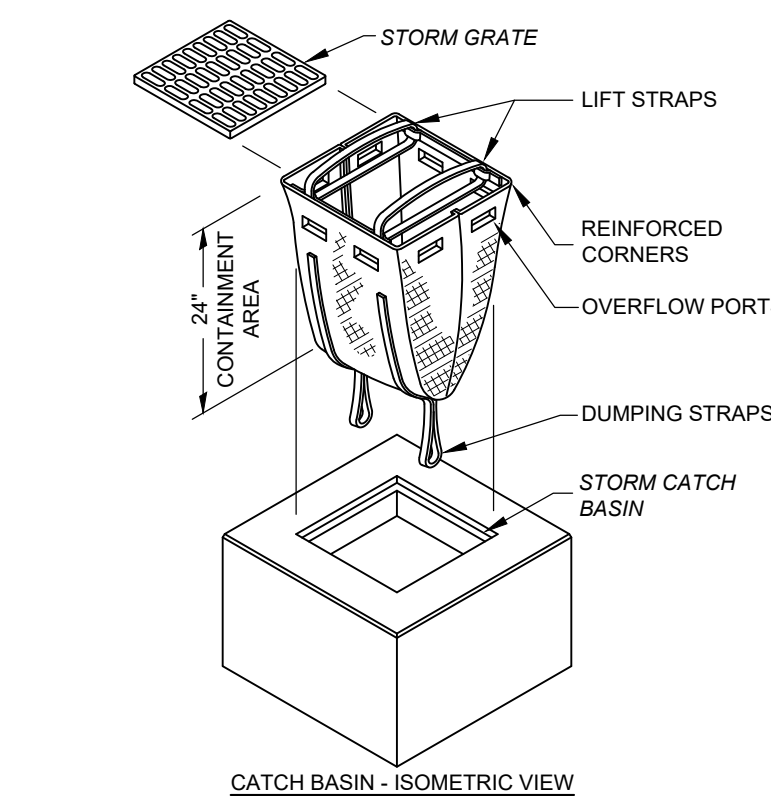

**STORM DRAIN INLET PROTECTION DETAIL**  
SCALE: NONE

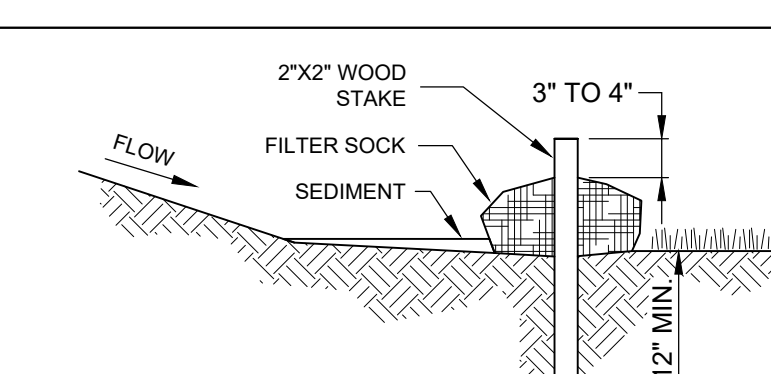

- NOTES:**
- FILTER SOCKS SHALL BE 3 OR 5 MIL. CONTINUOUS, TUBULAR, HDPE 3/8" KNITTED MESH NETTING MATERIAL, FILLED WITH COMPOST.
  - COMPOST SHALL BE WEED, PATHOGEN AND INSECT FREE, FREE OF ANY REFUSE, CONTAMINANTS OR OTHER MATERIALS TOXIC TO PLANT GROWTH, BE DERIVED FROM A WELL-DECOMPOSED SOURCE OF ORGANIC MATTER, AND CONSIST OF PARTICLES RANGING FROM 3/8" TO 2".
  - FILTER SOCKS SHALL BE PLACED ON A LEVEL LINE ACROSS SLOPES PARALLEL TO THE BASE OF THE SLOPE.
  - FILTER SOCKS SHALL BE PLACED AT LEAST 5' FROM THE TOE OF SLOPE FOR SEDIMENT DEPOSIT.
  - BUILT UP SEDIMENT SHALL BE REMOVED WHEN IT HAS REACHED 1/3 THE FILTER SOCK HEIGHT.
  - WHEN A FILTER SOCK IS NO LONGER REQUIRED, IT SHALL BE DISPERSED ON-SITE.
  - THE MAXIMUM DRAINAGE AREA PER 100 FEET OF FILTER SOCK IS 1/2 ACRE AND IS DEPENDENT ON THE SLOPE:

MAX. SLOPE LENGTH ABOVE FILTER SOCK					
SLOPE	RATIO (H:V)	8'	12'	18'	24'
0% - 2%	0 - 50:1	125'	250'	300'	350'
2% - 10%	50:1 - 10:1	100'	125'	200'	250'
10% - 20%	10:1 - 5:1	75'	100'	150'	200'

**FILTER SOCK DETAIL**  
SCALE: NONE

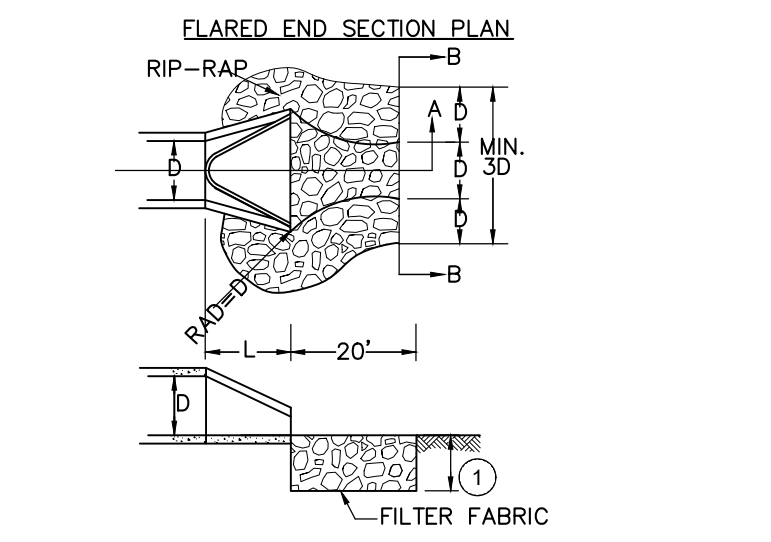

**FLARED END SECTION PLAN**  
SCALE: NONE



DATE	REVISION	NO
09/02/2025 <td> <td></td> </td>	<td></td>	

ISSUED FOR: MEMORIAL PARK SPLASH PAD  
 ISSUE DATE: 09/02/2025  
 SCALE: MHEL  
 DESIGNED BY: MHEL  
 DRAWN BY: EODS  
 CHECKED BY: MHEL

**MEMORIAL PARK SPLASH PAD**  
 CITY OF INDEPENDENCE  
 KENTON COUNTY, KENTUCKY

**EROSION CONTROL DETAILS**

PROJECT NO.	36727
DISCIPLINE	CIVIL
SHEET NAME	BMP
SHEET	4
OF	7

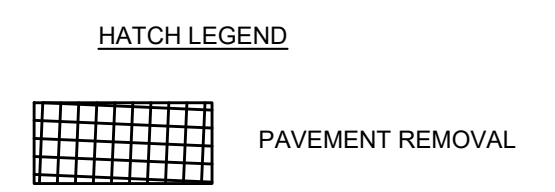
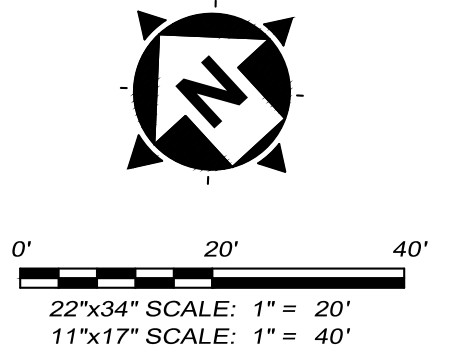

2181 CHAMBER CENTER DRIVE  
FORT MITCHELL, KENTUCKY 41017  
TEL: (609) 525-0644  
WWW.VERDANTAS.COM

ISSUED FOR:	DATE	REVISION	NO
ISSUE DATE:	09/02/2025		
SCALE:			
DESIGNED BY:	MHEL		
DRAWN BY:	EOOS		
CHECKED BY:	MHEL		

**MEMORIAL PARK SPLASH PAD**  
CITY OF INDEPENDENCE  
KENTON COUNTY, KENTUCKY

**EXISTING CONDITIONS /  
DEMOLITION PLAN**

PROJECT NO.	<b>36727</b>
DISCIPLINE	<b>CIVIL</b>
SHEET NAME	<b>DEMO</b>
SHEET	OF
<b>5</b>	<b>7</b>

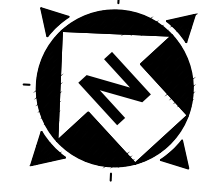
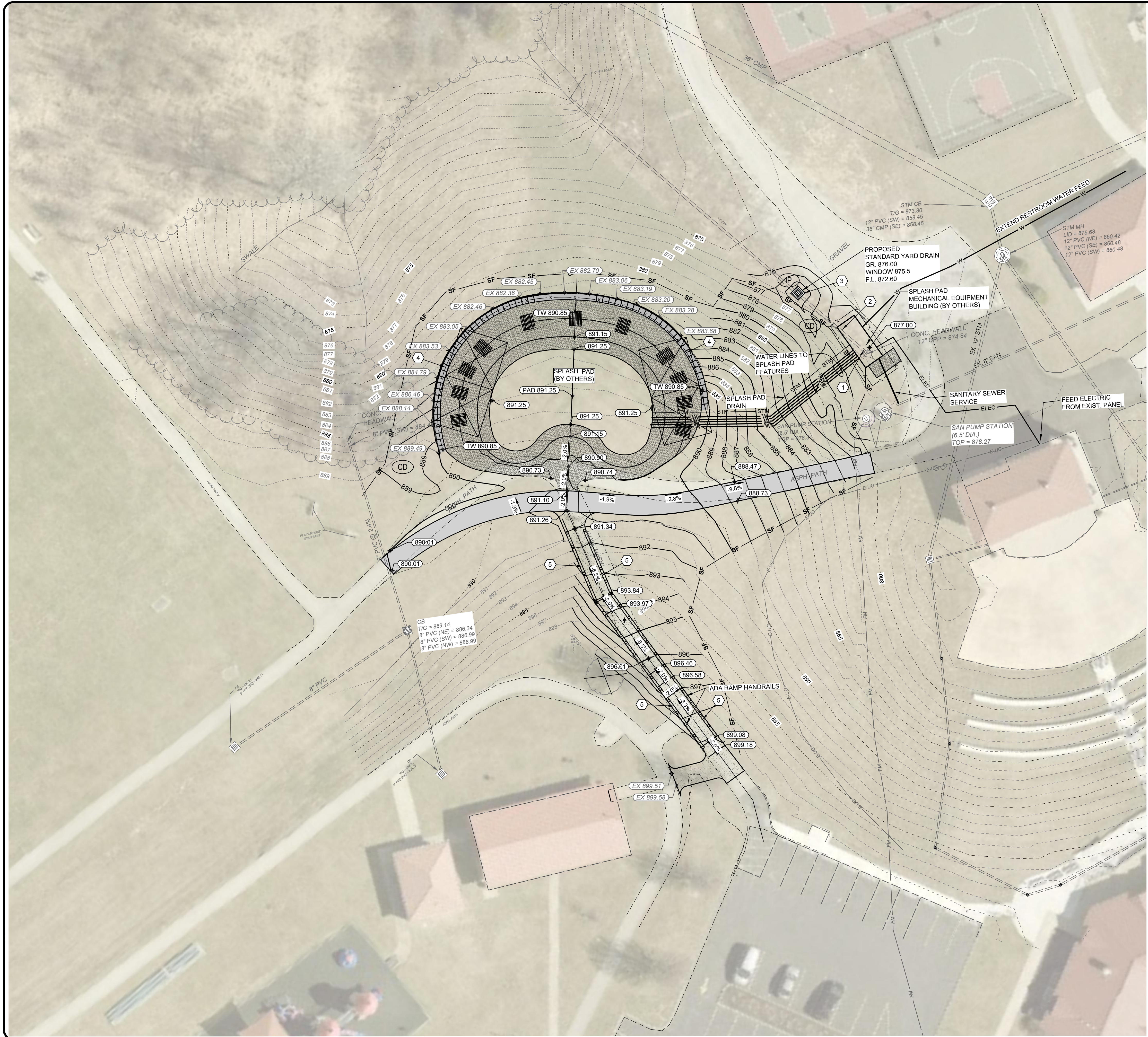

0' 20' 40'  
 22"x34" SCALE: 1" = 20'  
 11"x17" SCALE: 1" = 40'



**GENERAL CONSTRUCTION NOTES**

- 1 REMOVE EXISTING HEADWALL
- 2 REMOVE EXISTING STORM PIPE
- 3 INSTALL 2X2 YARD DRAIN PER DETAIL. CONNECT TO EXISTING PIPE.
- 4 INSTALL FENCE ON TOP OF RETAINING WALL PER DETAIL
- 5 HANDRAIL PER DETAIL. 1 1/2" DIAMETER PIPE PAINTED BLACK

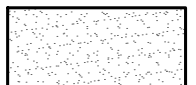
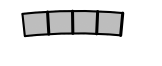
**HATCH LEGEND**

-  ASPHALT PATH - PER DETAIL
-  CONCRETE ACCESS PATH - PER DETAIL
-  PROPOSED RETAINING WALL - PER DETAIL

**EROSION CONTROL LEGEND**

- EROSION CONTROL LEGEND**
-  IP INLET PROTECTION (SEE DETAIL)
  -  SF PROPOSED SILT FENCE (SEE DETAIL)
  -  CD CHECK DAM (SEE DETAIL)

ISSUED FOR:	DATE	REVISION	NO
09/02/2025			
SCALE:			
DESIGNED BY:	MHEL		
DRAWN BY:	EODS		
CHECKED BY:	MHEL		

**MEMORIAL PARK SPLASH PAD**  
 CITY OF INDEPENDENCE  
 KENTON COUNTY, KENTUCKY  
**GRADING, LAYOUT AND UTILITY PLAN VIEW**

PROJECT NO.	<b>36727</b>
DISCIPLINE	<b>CIVIL</b>
SHEET NAME	<b>PLAN</b>
SHEET	<b>6</b>
OF	<b>7</b>

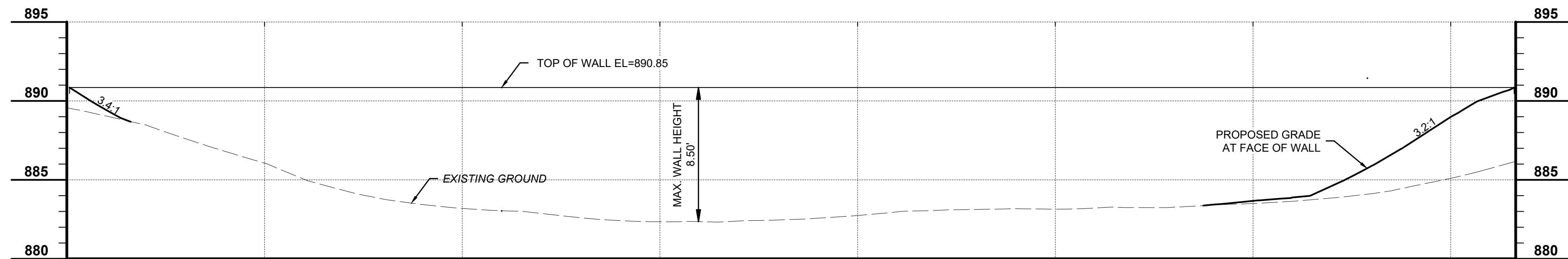

**RETAINING WALL PROFILE**  
 SCALES:  
 HORIZONTAL: 1" = 10'  
 VERTICAL: 1" = 5'

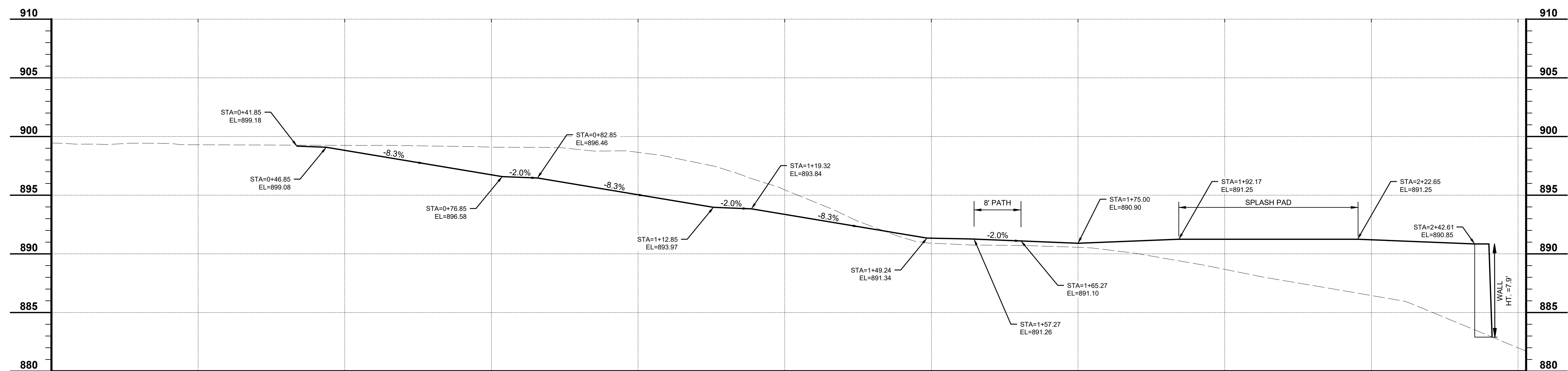

**ACCESS WALKWAY PROFILE**  
 SCALES:  
 HORIZONTAL: 1" = 10'  
 VERTICAL: 1" = 5'

NO	REVISION	DATE

ISSUED FOR:	09/02/2025	DESIGNED BY:	MHEL	CHECKED BY:	MHEL
ISSUE DATE:		DRAWN BY:	EOOS		
SCALE:					

**MEMORIAL PARK SPLASH PAD**  
 CITY OF INDEPENDENCE  
 KENTON COUNTY, KENTUCKY

**PROFILES**

PROJECT NO.	<b>36727</b>
DISCIPLINE	<b>CIVIL</b>
SHEET NAME	<b>PROF</b>
SHEET	OF
<b>7</b>	<b>7</b>